



StrongHandTools®

2015

STRONG HAND TOOLS

METRIC

CATALOG

www.stronghandtools.com

BE SURE TO LOOK FOR
GENUINE, PATENTED
STRONG HAND TOOLS®

We are dedicated to helping you work safely, efficiently, comfortably, and cost effectively.

We're on a mission to make "Better Tools at Better Prices." For over 30 years we have communicated with welders and craftsmen to develop innovative, quick-acting clamping tools that allow you to create a "proper" setup as the foundation for safe, and efficient work in welding, assembly, and repair applications. We've re-engineered traditional tools such as: Sliding Arm Clamps, Welding Magnetic Squares, Pliers, and Vises for improved performance in clamping and fixturing.

Strong Hand Tools Features and Benefits:

Our tools are multi-functional, and adaptable for all types of

workholding in welding, assembly, and repair operations.

All Strong Hand Tools are "Quick Acting" for fast setup and affordably priced to fit any budget.

We remain dedicated to designing the most innovative, time-saving, money-saving workholding tools to improve your efficiency, productivity, and profitability.

Find your local Strong Hand Tools Distributor at:

www.StrongHandTools.com.

BuildPro™

Modular Welding Tables
www.buildprotables.com



High Precision German Made Welding Tables
www.siegmundtables.com

VALTRA

Operating Accessories & Tooling Components
www.valtrains.com



Toggle Clamps & Latches
www.goodhandinc.com

* Call to request the full line catalogs 

USA Headquarters

7141 Paramount Blvd. Pico Rivera, CA 90660

Tel: 562-949-8625

Fax: 562-949-4875

sales@stronghandtools.com

Europe Sales

Pražská 410/11
67401 Třebíč, Czech Republic

Tel: +420 607 088 466

Fax: +420 568 853 213

sales@stronghand.eu

China Sales

No. 605 Huabo Rd, Huating
Town, Jiading District,
Shanghai, China 201816









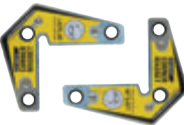

Tel: +86-21-59103639

Fax: +86-21-59102951

sales@stronghandtools.com



TABLE of CONTENTS

<p>Welding Clamps <i>4-in-1 Clamps, Utility Clamps, Ratchet Action, MagSpring Clamps</i></p>	<p>4</p>	
<p>Adjust-O Magnets <i>Adjust-O Magnet Squares, and Angle Magnets, Adjust-O Dual Switch Magnets, Mini Magnets, Multi-Angle</i></p>	<p>10</p>	
<p>Specialty Magnetic Clamps <i>Corner Magnets, Adj. V-Pads, MagTabs, Sheet Metal, Snake, and Gusset Magnets</i></p>	<p>14</p>	
<p>Pliers <i>Round & Swivel Tip Pliers, Pipe Pliers, JointMaster Angle Clamps, Ground Hog Grounding Clamps</i></p>	<p>18</p>	
<p>NEW! Modular Clamp & Grinder Rests <i>Hand Rest Kit, MIG / TIG Gun Holders</i></p>	<p>24</p>	
<p>2 & 3 Axis Fixture Vises <i>Welders Angle Clamps, Portable MagVises</i></p>	<p>26</p>	
<p>Hold Down Clamps <i>Modular Platen Clamps, and other hold down clamps.</i></p>	<p>28</p>	
<p>Nomad™ Welding Tables</p>	<p>34</p>	
<p>Accessories</p>	<p>36</p>	
<p>Other Product Lines</p>	<p>38</p>	



4-IN-1™ Utility Clamping System

The most versatile Sliding Arm Clamps in the market.



ONE Clamp... FOUR functions.

UD Models:
Remove the Key Ring.

UE,UF,UG,UM Models:
Press the Spring Stop.

UP Models:
Remove the Screw Stop.



Standard Pad



Replaceable Heavy Duty Pad

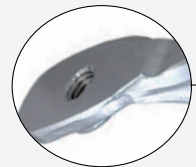

Tapped Hole
For attaching accessories such as the V-Pad or Extender Block.

Removable / Reversible Clamp Arm

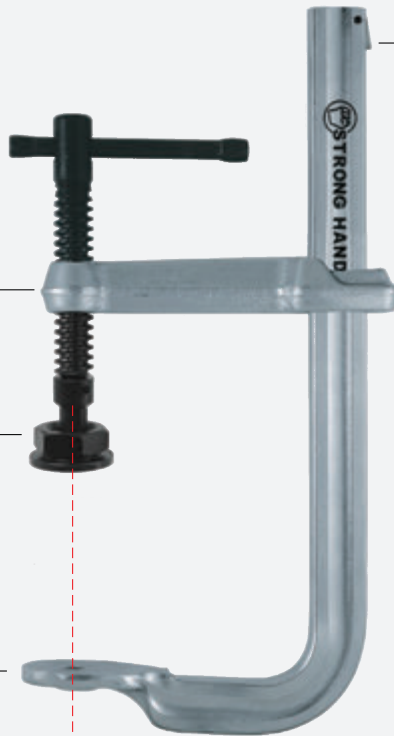

NEW Utility Clamp feature for **FASTER** setup!

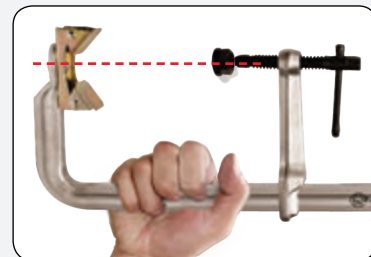

ALL Heavy Duty Replaceable Pads self-align with the spindle for fast workpiece contact and faster setup.



Extender Block



V-Pad

The strong, economical 4-IN-1 Utility Clamps adapt to serve four different applications.

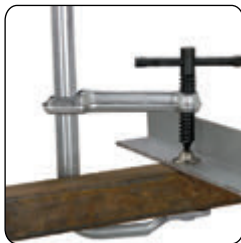

1. Standard

Sliding Arm Clamps are 10x faster than a C-Clamp!



2. Pipe

Add the exclusive V-Pad to create a Pipe Clamp!

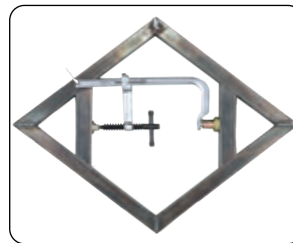

3. Spreader

Reverse the clamp arm and create a Spreader Clamp.

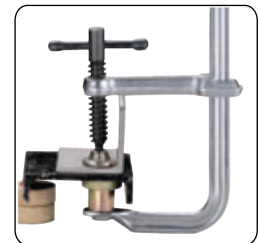

4. Step-Over

Add the Extender Block to create a Step-Over Clamp.

BEST SELLERS

“

I've been able to replace my old set of five C-Clamps with my new 4-in-1 Clamp.”

- Mark T.



See large V-Pad Below

4-IN-1™ Utility Clamping System

Part No.	Capacity (mm)	Throat Depth (mm)	Clamping Pressure (kg)	Pads	Rail Size (mm)	Tapped Hole	Weight (kg)
UD45M-C3	114	83	230	Standard	16 x 8	M8	0.6
UD65M-C3	165	83	230	Standard	16 x 8	M8	0.7
UF65M-C3	165	120	450	Standard	22 x 11	M10	1.3
UG85M-C3	216	120	550	Standard	25 x 12	M10	1.9
UG125M-C3	318	120	550	Standard	25 x 12	M10	2.1
UG1257M-C3	318	180 <i>*Deep Throat</i>	360	Standard	25 x 12	M10	2.9
UM85PM-C3	216	140	1,100	Standard	30 x 14	M10	3.0
UM105PM-C3	267	140	1,100	Standard	30 x 14	M10	3.4
UM125M-C3	318	140	1,100	Heavy Duty	30 x 14	M10	3.5
UM165M-C3	419	140	1,100	Heavy Duty	30 x 14	M10	4.0
UM205M-C3	521	140	1,100	Heavy Duty	30 x 14	M10	4.5
UP205M-C3	521	180 <i>*Deep Throat</i>	2,200	Heavy Duty	40 x 19	M10	7.3

4-in-1 Accessory Pack



The 4-IN-1 Clamp Kit comes complete with the V-Pad and Extender Block accessories.
 Create your 4-IN-1 Kit with the 4-IN-1 Accessory Pack!
 (See detailed dimensions at page 37)

Part No.	Description	Weight (kg)
XDVBM	For UD Models (Includes XDV, XDB1M)	0.1
XFVBM	For UE, UF, UG Models (Includes XFV, XFBM)	0.3
XMVBM	For UM Models (Includes XMV, XMB2M)	0.5
XPVBM	For UP Models (Includes XPV, XPB3M)	0.9

Utility Clamps

Utility Clamps set-up 10x faster than a C-Clamp! Create your 4-IN-1 Kit with the 4-IN-1 Accessory Pack!

Heavy Duty



- Clamping Pressure: 2,200 kg
- Throat Depth: 180 mm

* Heavy Duty Replaceable Pads

Part No.	Capacity (mm)	Throat Depth (mm)	Clamping Pressure (kg)	Rail Size (mm)	Tapped Hole	Weight (mm)
UP125M	318	180	2,200	40 x 19	M10	5.6
UP165M	419	180	2,200	40 x 19	M10	6.2
UP205M	521	180	2,200	40 x 19	M10	6.8
UP245M	622	180	2,200	40 x 19	M10	7.5
UP405M	1,020	180	2,200	40 x 19	M10	10.0
UP605M	1,537	180	2,200	40 x 19	M10	12.7

Regular Duty with Heavy Duty Pads



- Clamping Pressure: 1,100 kg
- Throat Depth: 140 mm

* Heavy Duty Replaceable Pads

Part No.	Capacity (mm)	Throat Depth (mm)	Clamping Pressure (kg)	Rail Size (mm)	Tapped Hole	Weight (kg)
UM65M	165	140	1,100	30 x 14	M10	2.5
UM85M	216	140	1,100	30 x 14	M10	2.7
UM105M	267	140	1,100	30 x 14	M10	2.9
UM125M	318	140	1,100	30 x 14	M10	3.2
UM165M	419	140	1,100	30 x 14	M10	3.5
UM205M	521	140	1,100	30 x 14	M10	4.0

Regular Duty with Standard Pads



- Clamping Pressure: 1,100 kg
- Throat Depth: 140 mm
- Standard Pads

Part No.	Capacity (mm)	Throat Depth (mm)	Clamping Pressure (kg)	Rail Size (mm)	Tapped Hole	Weight (kg)
UM85PM	216	140	1,100	30 x 14	M10	2.9
UM105PM	267	140	1,100	30 x 14	M10	3.0
UM125PM	318	140	1,100	30 x 14	M10	3.1

All Strong Hand Tools® Utility Clamps are made of high quality heat treated steel and nickel / chrome plated for strength and durability.

Light & Medium Duty



UD Series with Key Ring Stop



UE, UF, UG Series with Spring Stop

- Clamping Pressure: 230 - 544 kg
- Throat Depth: 83 - 180 mm
- Standard Pads

Part No.	Capacity (mm)	Throat Depth (mm)	Clamping Pressure (kg)	Rail Size (mm)	Tapped Hole	Weight (kg)
UD45M	114	83	230	16 x 8	M8	0.4
UD65M	165	83	230	16 x 8	M8	0.5
UD85M	216	83	230	16 x 8	M8	0.6
UE85M	216	100	390	20 x 10	M10	1.1
UE125M	318	100	390	20 x 10	M10	1.2
UF65M	165	120	450	22 x 11	M10	1.1
UF100M	254	120	450	22 x 11	M10	1.3
UG85M	216	120	550	25 x 12	M10	1.6
UG125M	318	120	550	25 x 12	M10	1.8
UG205M	521	120	550	25 x 12	M10	2.2
UG1257M	318	180 * Deep Throat	370	25 x 12	M10	2.7
UG1657M	419	180 * Deep Throat	370	25 x 12	M10	3.0

J-Clamp Step-Over



UD, UF, UG Series



UM Series

* Heavy Duty Replaceable Pads

Part No.	Capacity (mm)	Throat Depth (mm)	Clamping Pressure (kg)	Rail Size (mm)	Tapped Hole	Weight (kg)
UD45JM	114	83 (50)	230	16 x 8	M10	0.6
UF100JM	254	120 (75)	450	22 x 11	M10	1.5
UG105JM	267	120 (75)	550	25 x 12	M10	2.3
UM125JM*	318	140 (120)	1,100	30 x 14	M10	3.7
UM205JM*	521	140 (120)	1,100	30 x 14	M10	4.2

Slide-on Sidekicks

Mount onto Clamps for 2-axis horizontal clamping.
(See Page 37 for accessories details.)

Ratchet Action & MagSpring™ Clamps

Quick-Set Clamps for fast, convenient clamping.

Ratchet Action Utility Clamps

Ratchet mechanism ensures rapid, vibration and torsion resistant clamping.

- Clamping Pressure: 460 - 544 kg
- Throat Depth: 120 mm
- Tapped Hole: M10

Part No.	Capacity (mm)	Clamping Pressure (kg)	Rail Size (mm)	Weight (kg)
UF65RM	180	460	22 x 11	1.2
UF100RM	254	460	22 x 11	1.3
UF100JRM	254	460	22 x 11	1.4
UG85RM	216	550	25 x 12	1.6
UG125RM	318	550	25 x 12	2.2
UG205RM	521	550	25 x 12	2.6



UF100JRM

Sturdy J-shaped 76 mm return for step-over applications.

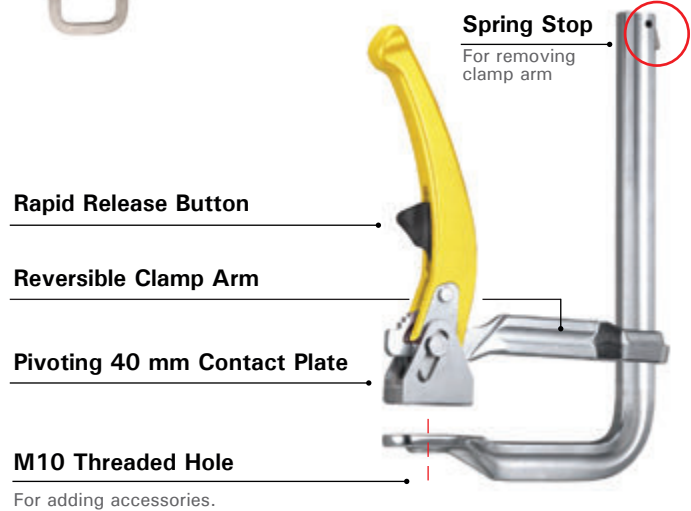

MagSpring™ Clamps

The spring-loaded, one-handed clamp with quick-set magnetic V-Pad.

Quick & Easy to Use!

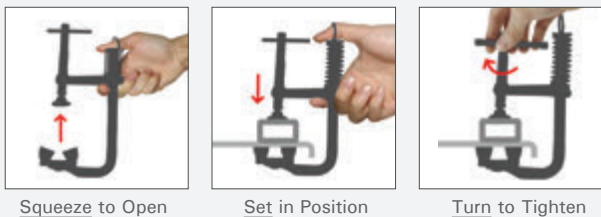

The Spring Loaded Arm in conjunction with the magnetic V-Pad allows users to free up one hand to position the workpiece.

- Tapped Hole: M8



Spring Loaded Arm

The MagSpring™ holds onto metal, wood and synthetic materials.

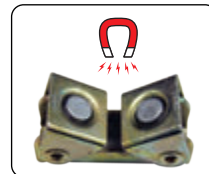

Adjustable Magnetic V-Pad

Instantly adjusts for different shapes: round, flat, and angle steel surfaces.



Part No.	Capacity (mm)	Throat Depth (mm)	Clamping Pressure (kg)	Weight (kg)
UBV65M	115	64	140	0.4
UDV45M	75	83	230	0.5
UDV65M	115	83	230	0.5

EZ Grip Ratchet & Economy Light Duty Clamps

Multi-Purpose Clamps for woodworking and metalworking.

EZ Grip Ratchet Clamps

The lightweight, Quick-Set Ratchet Clamp

- Ideal for firm, no-mar holding of aluminum, wood and non-metallic materials.
- Hold delicate materials securely in drilling, cutting, assembly, or bending applications. Great for assembly work.
- The lightweight clamp is easy to handle, easy to set, lock, and release.
- Max. Clamping Pressure: 120 kg
- Throat Depth: 76 mm

Part No.	Capacity (mm)	Rail Size (mm)	Weight (kg)
VER45	120	19 x 6	0.3
VER85	220	19 x 6	0.4
VER125	320	19 x 6	0.6
VER165	420	19 x 6	0.7

Pull Finger-Loop

For one finger locking.

Press Release Trigger

Nylon (Non Marring) Surfaces

Protects work surfaces

Step Over



Included accessories:



Non Marring Slip On Pads
Neoprene cap



50 mm Extender Block
Part No: VER01
For Step-Over applications.
Snaps into jaw hole.

Economy Light Duty

- Clamping Pressure: 140 kg
- Throat Depth: 65 mm
- Standard Pads



Part No.	Capacity (mm)	Rail Size (mm)	Tapped Hole	Weight (kg)
UB45AM	120	13 x 6	M6	0.4
UB65AM	170	13 x 6	M6	0.4
UB85AM	220	13 x 6	M6	0.5
UB125AM	320	13 x 6	M6	0.5
UB165AM	420	13 x 6	M6	0.6
UB205AM	520	13 x 6	M6	0.6

Non-Marring Rubber Pads

Slip-on top and bottom clamp jaws to protect wood, metal, or synthetic work surfaces.

Each package contains 2 sets.



Part No.	Description	Weight (kg)
XBP2	For UB model clamps	0.02
XDP2	For UD model clamps	0.02
XEP2	For UE model clamps	0.03
XFP2	For UF model clamps	0.03
XGP2	For UG model clamps	0.04

Adjust-O™ Magnet Squares

The **original** magnet squares featuring On/Off switches.



It's so much easier to set-up and hold my work with the On & Off Adjust-O Magnets because I'm not fighting the magnetic force."

- Jason T.

Adjust-O™ Magnet Squares

The fast & easy way to hold metal workpieces at 30°, 45°, 60° & 90°.

- Turn the magnet Off when setting up, turn On when you're ready to work. Fast and safe set-up!
- Ideal for round and square tubing, angle, and flat stock.
- Easy to clean. Simply turn Off and wipe.

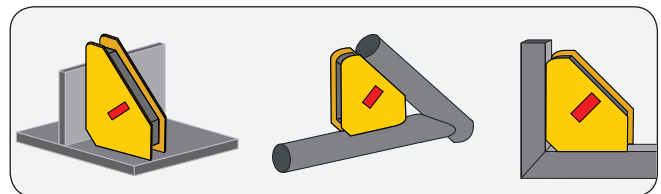

Made with strong rare earth magnets.
Fully enclosed for easier cleaning.

The On/Off switch



MSA45
45°, 90°



MSA48-HD
45°, 90°



MSA53-HD
Multi-Angles: 30°, 45°, 60°, 90°

Part No.	Max. Pull Force (kg)	Dimension (mm)	Weight (kg)
MSA45	30	111 x 95 x 25	0.5
MSA46-HD	40	111 x 95 x 29	0.7
MSA47	35	152 x 130 x 32	1.0
MSA48-HD	75	152 x 130 x 35	1.4
MSA53-HD	65	152 x 130 x 35	1.4

*Magnetic force is based on the longest side of Magnet with 10 mm thick steel.

3rd-Axis Magnetic Posts

Optional accessory for ALL MSA Magnets

- Quickly and easily set-up 3-sided work such as tank and gusset.
- Use on either side of the magnet squares.

MXE13

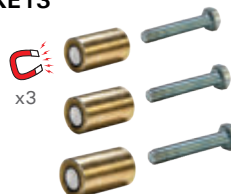

Holding a 3-Axis workpiece.

Adjust-O™ Angle Magnet Squares

Angle magnet squares with the convenience of On/Off switches.

Adjust-O™ 90° Dual Switch Magnet Squares

For professional jobs that demand strong hold down forces.
Holds flat and round metal work pieces.

- Two On/Off switches for independent operation.
- Turn the magnets Off when setting up, turn On when you're ready to work. Easy and safe set-up!
- Machined flat and V-surfaces are ideal for round and square tubing, angle, and flat stock.
- Choose from 55 - 120 kg pull force.



MS2-80
55 kg Max. pull force

MS2-90
120 kg Max. pull force

Part No.	Max. Pull Force (kg)	Dimension (mm)	Weight (kg)
MS2-80	55	152 x 152 x 38	1.2
MS2-90	120	197 x 197 x 48	2.7

*Magnetic force is based on 10 mm thick steel.

Adjust-O™ Angle Magnet

- Adjustable from 30° - 275° with two On/Off switches.
- Machined flat surfaces and nickel/chrome body.
- V-Groove surfaces securely hold round and square tubing, angle, and flat stock.

MAV120

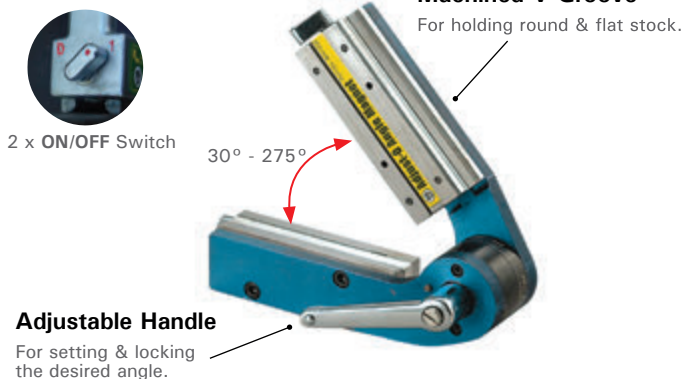

Part No.	Angles	Max. Pull Force (kg)	Dimension (mm)	Weight (kg)
MAV120	30° - 275°	50	197 x 197 x 95	2.4

*Magnetic force is based on 10 mm thick steel.

Mini & XYZ Magnet Squares

Set-up 2 or 3-Axis stock at multiple angles.

Mini Magnet Squares

- At just 60 mm in height, Mini Magnets provide low profile holding of stock in tight, hard to reach areas.
- Use as many as needed for light duty holding of stock at multiple points for greater accuracy in fixturing with odd-shaped stock.
- Perfect for use around the shop, and compact enough to carry along for use out in the field.



MS346AT
Mini Multi Angle



MS350A
Multi-Angle

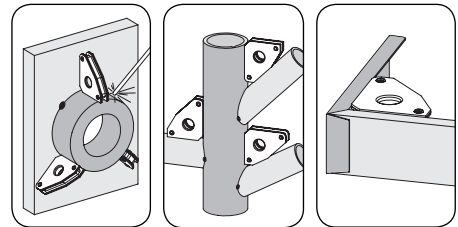

Part No.	Angles	Max. Pull Force (kg)	Dimension (mm)	Weight (kg)
MS346AT Twin Pack	30°, 60° 45°, 90°	10	59 x 50 x 16	0.3
MS346AK 6-Pack	30°, 60° 45°, 90°	10	59 x 50 x 16	0.8
MS350A	30°, 60° 45°, 90°	13.6	86 x 75 x 16	0.3

*Magnetic force is based on the longest side of Magnet with 10 mm thick steel.



XYZ Magnet Squares

- Quickly and easily set-up 2 or 3-Axis workpieces.
- New Magnetic Face Plate features two rare earth disc magnets for 3rd axis holding. Turn the Magnetic Face Plate with your finger to desired position. Quickly snap together 2 or 3 axis set-ups for tack welding.
- Use the face plate as an edge guide when joining square tubing and sheet metal parts.



(Front) (Back)



MS350
Rotatable Magnetic Face Plate

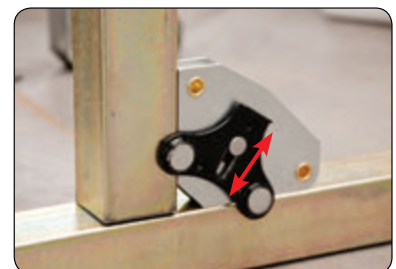
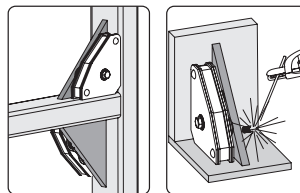
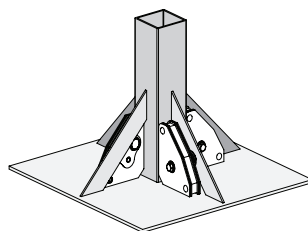

The face plate can be slid in and out of the boundary edges of the magnet body.



The 3-Axis Magnetic Plate features two rare earth disc magnets for 3rd axis holding.

Part No.	Description	Max. Pull Force (kg)	Dimension (mm)	Weight (kg)
MST348	Twin Pack	10	59 x 50 x 22	0.3
MS350	Each	13.6	86 x 75 x 16	0.3

*Magnetic force is based on the longest side of Magnet with 10 mm thick steel.

Multi-Angle & Heavy Duty Magnets

Tools for sheet metal and large stock holding.

Standard Magnet Squares

Holding at multiple angles while soldering, brazing, and welding at 30°, 45°, 60°, and 90°.

- The compact size of the Mini Magnets makes it easy to pack, store, and carry for use anywhere!
- Center hole for easy handling.
- Fully enclosed for easier cleaning.



MS45
45°, 90°



MS60
60°, 90°



MS346C
Multi-Angle



Part No.	Angles	Max. Pull Force (kg)	Dimension (mm)	Weight (kg)
MS45	45° - 90°	30	111 x 95 x 19	0.5
MS60	60° - 90°	25	111 x 95 x 19	0.5
MS346C	30°, 60° 45°, 90°	40	140 x 111 x 19	0.5

*Magnetic force is based on the longest side of Magnet with 10 mm thick steel.

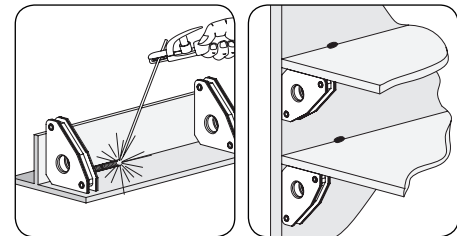

NEW A-Frame HD Magnet

New for sheet metal and large stock holding. Hold large workpieces in the upright position.



Three independent ON / OFF Switches.



Machined flat and V-faces hold round, square, flat, and angled stock.

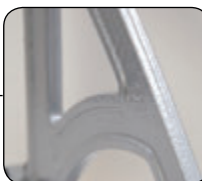

Aluminum body

Part No.	Max. Pull Force (TOTAL) (kg)	Dimension (mm)	Weight (kg)
MS2-300	120	330 x 330 x 32	4



Corner Magnets & Magnetic V-Pad Kit

Time saving magnetic tools for use in the shop & in the field.

Corner Magnets

- Create 90° corners by holding from the outside, providing you with an unobstructed area for inside tack welds.
- One side corner "relief" provides clearance for tall lips.
- Use the outer edges of the Corner Magnet for setting up materials at 60°.

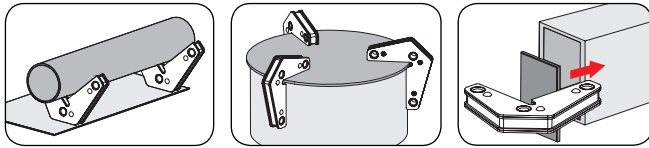
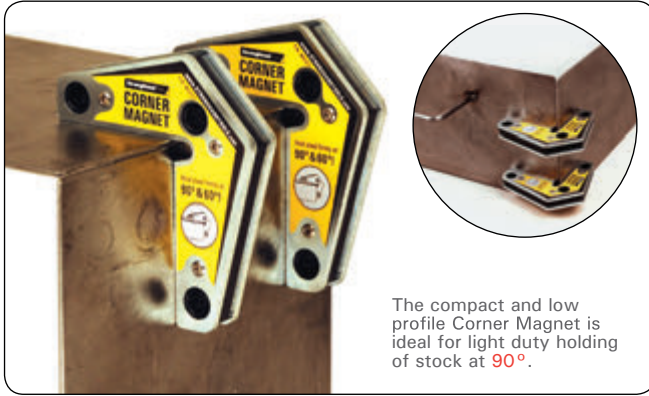

Part No.	Description	Dimension (mm)	Max. Pull Force (kg)	Weight (kg)
MST327	Twin Pack 90° & 60°	83 x 95 x 16	14	0.4

*Magnetic force is based on the longest side of Magnet with 10 mm thick steel.

Adjustable Magnetic V-Pads Kit

Light duty & tight spot holding! Build, Hold, and Position Steel.

- Hold and position round, flat, and square parts in light duty substructure applications!
- Each V-Pad contains **4 rare-earth magnets**.

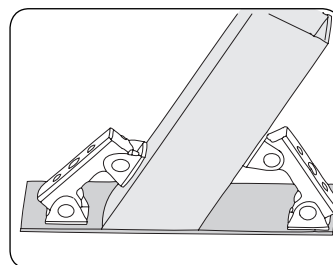
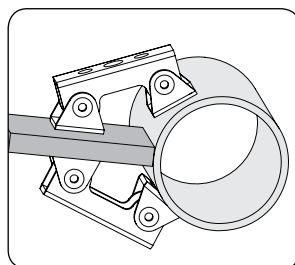
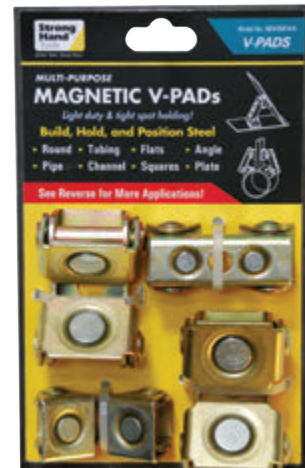
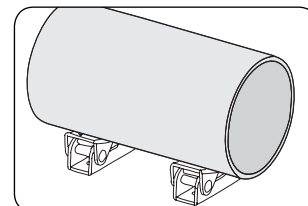
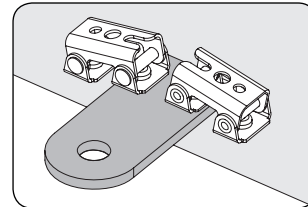

Part No.	Description	Max. Pull Force (kg)	Weight (kg)
MVDF44	2 Regular V-Pads (XDV4) & 2 Large V-Pads (XDV4)	8	0.4

*Magnetic force is based on 10 mm thick steel.

MagTab™ (DUO) & MagTab Square

Time saving magnetic tools for use in the shop & in the field.

UNIQUE MagTab™ & New MagTab™ AL



The better, faster way to hold tabs in place for tack welding!

- Hold tabs, or any small metal pieces, parallel or perpendicular to the substructure.
- The Adjustable Magnetic V-shape base adjusts for different shapes: round, flat, angle metal surfaces.

6-pc Magnets ea.



MFT10

MFT17 (AL)



Perpendicular tab



Positioning handle



Parallel Tab

Part No.	Dimension (mm)	Max. Pull Force (kg)	Weight (kg)
MFT10	100 x 76 x 32	8	0.2
MFT17	111 x 73 x 38	8	0.3

*Magnetic force is based on 10 mm thick steel.

MagTab™ AL

- Made of machined, die cast aluminum for accuracy.
- Two mounting holes provide a wider range of adjustment, and allow for off-set positioning on pipes and tubes up to 76 mm in dia.



NEW MagTab Square

Position metal plates on square tubes.

Hold small metal plates parallel to square tubes. Stop tabs allow MagTab Square to quickly snap into position on tubing edge.

Two Adjustable Magnetic Hex Bolts position and hold steel plates at a precise location.

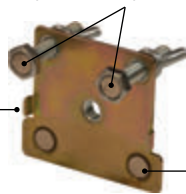

Stop tabs allow MagTab Square to quickly snap into a fixed position on tubing edge.

Two disc magnets in the MagTab Square base provide light duty holding against square tubes.

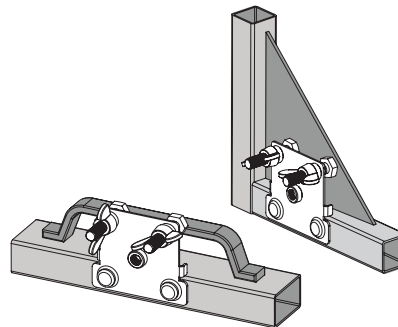

Part No.	Description	Weight (kg)
MTH20	MagTab (MFT10) and MagTab Square (MGT24) Combo	0.3

MagTab DUO

No clamping edges required! Clamp anywhere on flat, round or angled surfaces!
Position and hold pipes, tubes or plates at two points, on ONE side of your workpiece, leaving ample space on the other side for welding.

Part No.	Description	Weight (kg)
MFT12	<i>Symmetric</i> MagTabs (one facing left & one facing right)	0.5

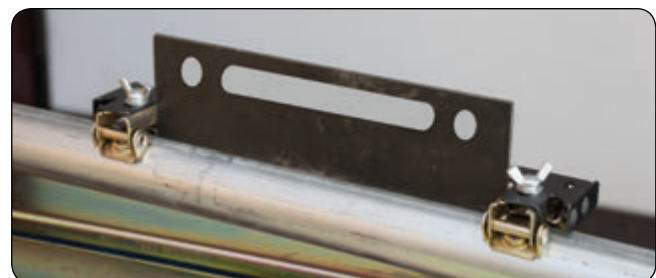

Sheet Metal Magnet & Large Magnetic V-Pads

Time saving magnetic tools for use in the shop & in the field.

Sheet Metal Magnets

Hold sheet metal and automotive metal panels firmly in a positive location for cutting, welding, tacking, painting and repair operations.

Rare earth disc magnets in the magnetic plate have superior gripping power. Use horizontally or vertically. The strong, generously sized plastic handle makes placing, moving, and removing the Sheet Metal Magnets fast and easy.

Part No.	Description	Weight (kg)	Max. Pull Force (kg)
MCB82	Sheet Metal Magnets (Twin Pack)	0.5	45
MCB802	Replaceable Rubber Pad x 10 pcs.	--	--
MCB84	2 pcs. Sheet Metal Magnets, 1 pc. Mountable / Magnetic Wall Caddy, 3 pcs. Plastic Hold Down Straps.	0.9	--

*Magnetic force is based on 10 mm thick steel.



NEW Large Magnetic V-Pads

Hold and position steel stock at any angle in fixturing, welding, inspection and repair applications.

Four rare earth magnets in each pad provide secure gripping power for rapid and convenient holding and positioning.

Pads pivot to hold onto round, square or flat metal surfaces.

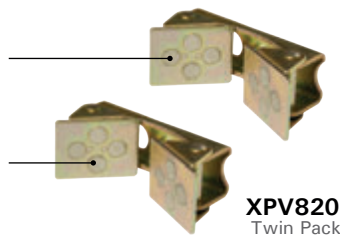

Large, removable comfort handle for control in placing, positioning and removing the clamp.

The adjustable magnetic V-Pad is easy to remove. Pull back firmly on the handle to break the magnetic force.

Protective Rubber Pads included.

XPV830

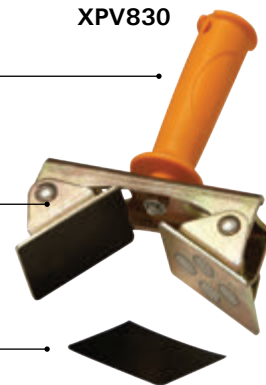

Part No.	Description	Dimension (mm)	Max. Pull Force (kg)	Weight (kg)
XPV820	Large Magnetic V-Pad, Twin Pack	121 x 51 x 48	26	1
XPV830	Large Magnetic V-Pad w/Handle	121 x 51 x 158	26	0.6
XPVR80	Replacement adhesive backed rubber pad, 10 pc. pack			--

Snake, Gusset Magnet & Magnetic Nuts & Bolt Holders

Time saving magnetic tools for use in the shop & in the field.

Snake Magnets



The Third Hand - Holds, Bends, Twists

- Comes complete with 2 magnetic pads and 1 spring clamp.
- MFC312 has a 305 mm cable with **2 magnetic V-pads**.
- MFC318 has a 450 mm cable with **2 flat magnetic pads**.

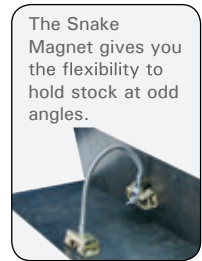
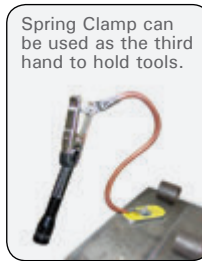
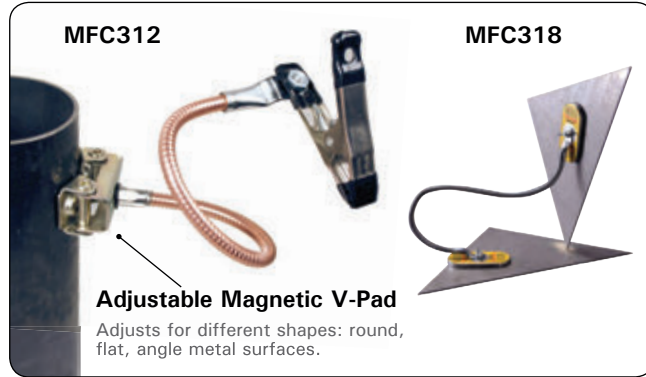

Part No.	Description	Max. Pull Force (kg)	Weight (kg)
MFC312	305 mm flex cable, 1 clamp, 2 Adjustable Magnetic V-pads	8	0.5
MFC318	450 mm flex cable, 1 clamp, 2 flat Magnetic Pads	6	0.6

*Magnetic force is based on 10 mm thick steel.

Magnetic Nut & Bolt Holders

Hold Nuts and Bolts in place before tightening.

MNB50 5 piece Set includes:

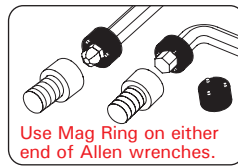

Use Mag Ring on either end of Allen wrenches.

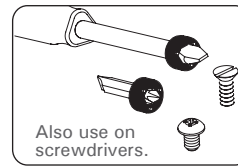

Also use on screwdrivers.

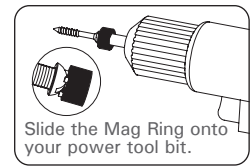

Slide the Mag Ring onto your power tool bit.

- Hold and place nuts and bolts in hard to reach areas.
- Clip Magnetic Wrench Attachment on any size wrench to hold nuts and bolts in place before tightening.
- No more fumbling while trying to hold small parts!
- Ideal when working in tight spaces and hard to reach areas!
- Weight: 0.04 kg

UNIQUE Gusset Magnet

Simple tool to attach gussets, plates and panels to frames.

- Hold stock in position with ample clearance for tack welding.
- Three adjustable 38 mm Magnetic Hex Bolts can be pre-set to position and hold stock at the correct depth.

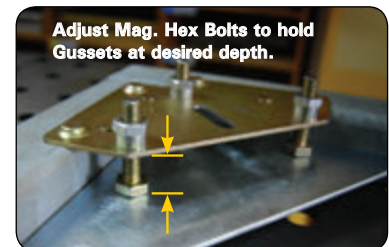
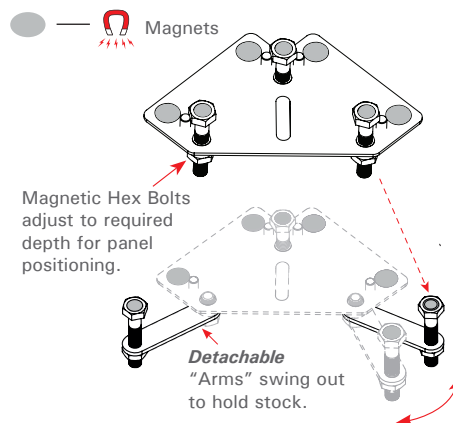

Adjust Mag. Hex Bolts to hold Gussets at desired depth.

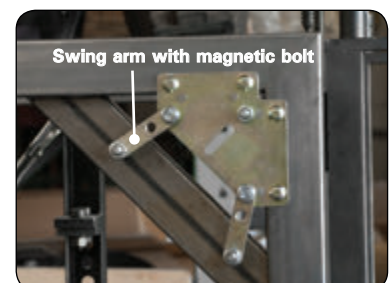

Swing arm with magnetic bolt

Part No.	Dimension (mm)	Arm Length (mm)	Magnets (pc)	Weight (kg)
MGH20	114 x 114	56	7	0.3

Improved Locking C-Clamps

Improved features for professionals and Do-It-Yourselfers.

Made of heat treated steel and nickel/chrome plated for strength and durability. Updated features help you work quickly, safely and efficiently.

Round Tip Model

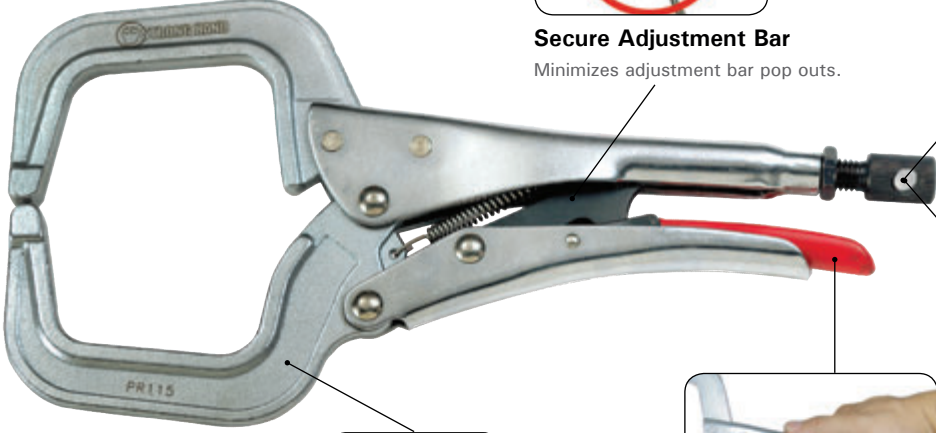

Secure Adjustment Bar
Minimizes adjustment bar pop outs.

Adjustment Screw
Large adjustment screw with a hole for easy torque.

Optional Crank Handle
See page 36 for detail

Cross Section
Made of heat treated steel and nickel/chrome plated for strength and durability.

Single Hand Release Handle
Vinyl coated release handles made for comfort and ease.

PR115

Swivel Pad Models



PR115S



PR18S



	Part No.	OAL (mm)	Throat Depth (mm)	Opening (mm)	Weight (kg)
Round Tip	PR6	165	46	56	0.2
	PR115	280	83	100	0.9
	PR18	450	254	114	1.4
Swivel Pad	PR6S	165	46	56	0.3
	PR115S	280	83	100	1.0
	PR18S	450	254	114	1.4

Multi-Purpose Pliers

Swivel and fixed head spindles for flexibility in clamping.

Multi-Purpose Pliers

PG634

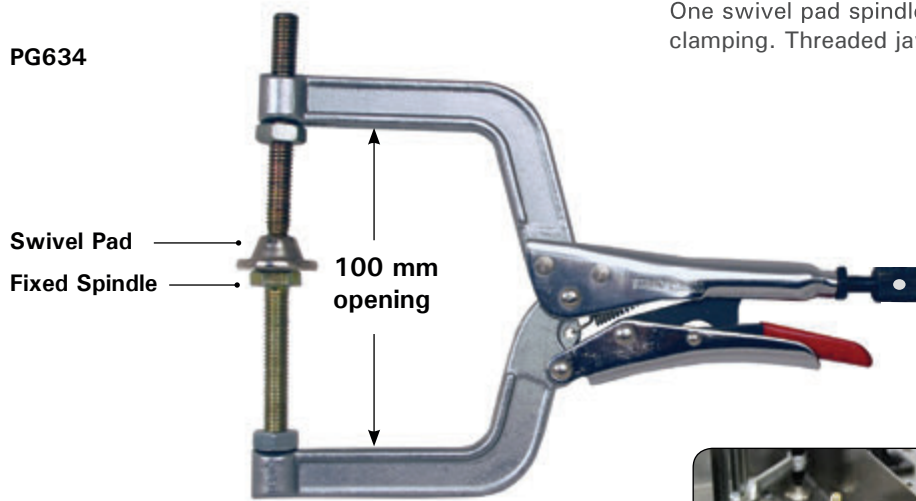

One swivel pad spindle and a fixed head spindle for flexible clamping. Threaded jaw holes allow addition of accessories.

Part No.	OAL (mm)	Throat Depth (mm)	Opening (mm)	Thread	Weight (kg)
PG634	216	76	100	M8	0.5
PG114M	280	89	100	M10	1.4



Adjustable Reach and Long Reach Multi-Purpose Pliers

Thread : M10 | Opening : 100 mm



PGA20M - Adjustable Reach Arms

Top Adjustable Spindle: No-mar rubber pads, pivoting head.

Bottom Adjustable spindle: No-mar rubber pads, fixed head.



PGA20S - Adjustable Reach Arms, with top and bottom fixed jaws, pivoting heads, and no-mar rubber pads.



Part No.	OAL (mm)	Throat Depth (mm)	Weight (kg)
PGA20M	585 - 740	350, 405, 460, 510	2.2
PGA20S	585 - 740	350, 405, 460, 510	2.2

Pipe Pliers

The convenient way to hold round or square tubes for butt-welding.

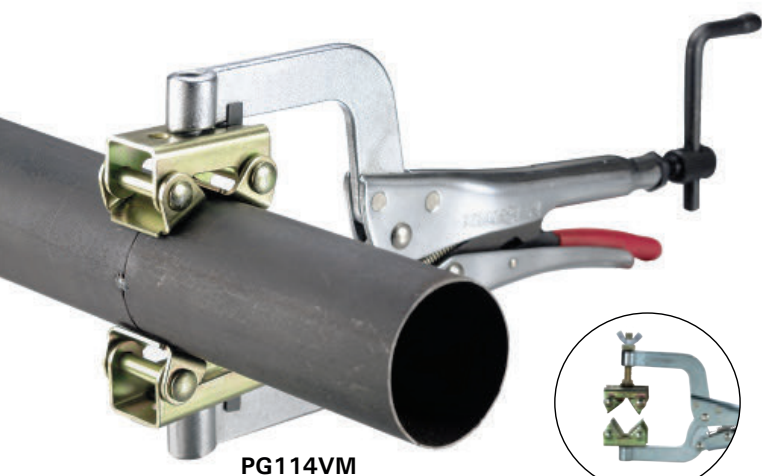

PG114VM

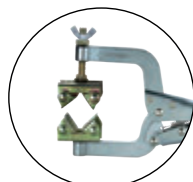

PG115VM

The V-Pads on the Pipe Pliers adapt to many different shapes & sizes.



PG622V
PG634V



PG635V



PG635VS



* Magnetic V-Pads and Stainless Steel V-Pads also available separately.

See Accessories page 37.

Part No.	OAL (mm)	Top V-Pad	Bottom V-Pad	Throat Depth (mm)	Opening (mm)	Thread	Weight (kg)
PG622V	150	Fixed	Fixed	50	25 - 50	M8	0.4
PG634V	216	Fixed	Fixed	76	50 - 80	M8	0.5
PG635V	216	Adjustable	Magnetic 0° & 45° rotatable	76	38 - 64	M8	0.5
PG635VS	216	Adjustable Stainless Steel	Stainless Steel 0° & 45° rotatable	76	38 - 64	M8	0.5
PG114VM	280	Fixed	Fixed	89	38 - 64	M10	1.3
PG115VM	280	Adjustable	Fixed	89	38 - 64	M10	1.3

Bench-Mount Pliers Holder

Convenient storage, or hands-free use

- Holds in Vertical & Horizontal positions.
- Wing nuts on both vertical and horizontal position locks pliers in place.

Part No.	Weight (kg)
PB11	0.1

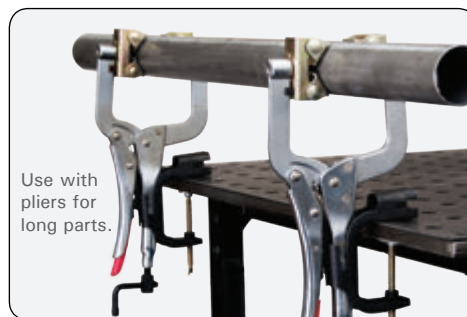
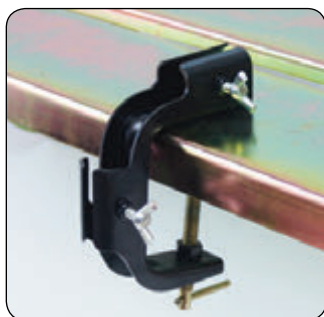

Use with pliers for long parts.

JointMaster™ Angle Clamping Tools

Fast, precise and affordable clamping tools for corners and T-joints.

PL Series

The **single-hand** corner clamping tool.

- Ideal for quick hold and release on metal, wood & synthetic materials.
- A “helping hand” to hold stock firmly at right angles while creating or repairing permanent joints.
- Comes with 1 pair of pliers.

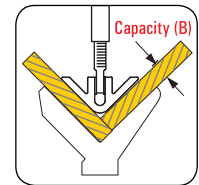
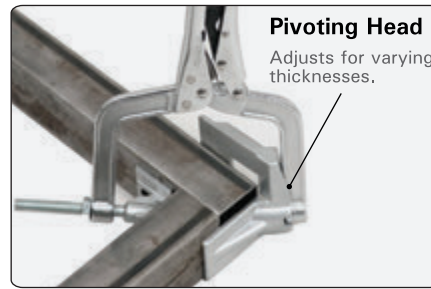

Capacity (B):
PL622 : 0 - 19 mm
PL634 : 0 - 32 mm

PT Series

The **90° Fixed** JointMaster™

- Retractable plate for edge alignment
- V-Grooves for holding round pieces.
- Ideal for holding two pieces of different thicknesses that require individual adjustments.
- Comes with 2 pairs of pliers.

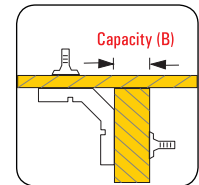
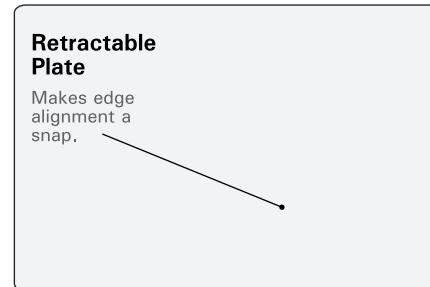

Capacity (B):
PT622 : 0 - 32 mm
PT634 : 0 - 76 mm

PA Series

The **Adjustable** JointMaster™

- Adjustable from 30° - 275°.
- Adjust to the desired angle & “lock” into position with the handle.
- Join round & flat workpieces, or materials with different thicknesses.
- Comes with 2 pairs of pliers.

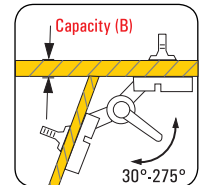

Capacity (B):
PA622 : 0 - 32 mm
PA634 : 0 - 76 mm

90° Clamp

- A quick way to hold workpieces at 90°.
- Capable of holding a 3-axis workpiece by adding a Pipe Pliers (see page 20).
- Wide opening offers unobstructed welding access.



UDI 365



PL / PT / PA Series

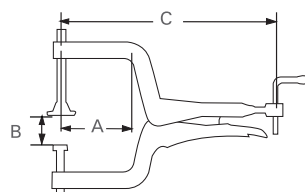

UDL365

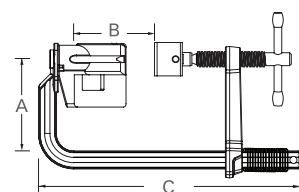

Part No.	Throat Depth (A) (mm)	Max.Capacity (B) (mm)	OAL (C) (mm)	Weight (kg)
PL634	76	32	216	0,5
PT634	76	76	216	1,1
PA634	76	76	216	1,1
UDL365	76	50	241	0,8

Locking Chain Pliers & Expand-O Pliers

The flexibility to clamp around odd shaped items!

Locking Chain Pliers

Holds 152 mm pipes with the standard 600 mm chain.

- Clamp around odd or odd shaped items.
- Hold two workpieces, or a group of materials securely in place while you weld.
- The ONLY Locking Chain Pliers with replaceable chains of various lengths! Chain lengths from 400 mm to 1,220 mm. Custom length chains available.

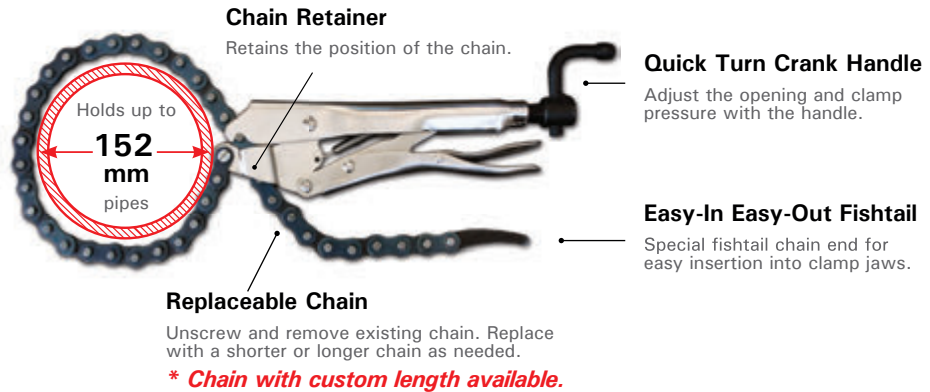

Part No.	Description (mm)	OAL (mm)	Weight (kg)
PC924	Standard Chain Pliers with 600 Chain	230	0.9
PXC16	400 Replaceable Chain	400	0.2
PXC36	910 Replaceable Chain	910	0.5
PXC48	1,220 Replaceable Chain	1,220	0.7

Expand-O Pliers

Unique, Reverse-Action Clamping Pliers!
Jaws move in opposite directions to push against two surfaces.

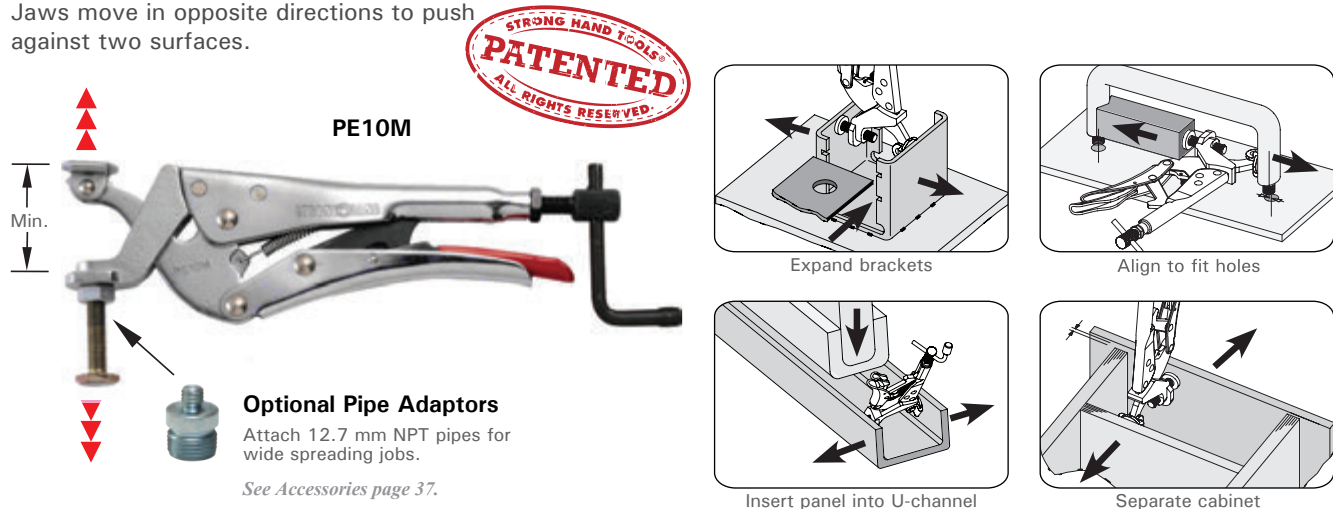

Part No.	OAL (mm)	Clamping Pressure (kg)	Thread	Min. (mm)	Stroke (mm)	Weight (kg)
PE6M	165	227	M8	25	19	0.2
PE10M	254	410	M10	35	35	0.8

PowerBase & Ground Hog Grounding Tools

High clamping pressure improves arc stability and reduces power consumption.

PowerBase™ Grounding Magnets

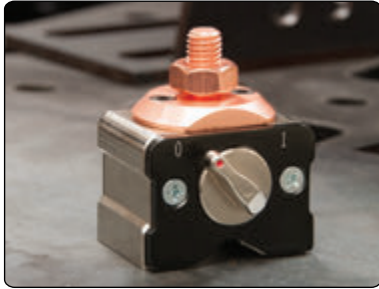

Turn OFF the PowerBase™ Grounding Magnet and metal chips fall away.

Power through your grounding applications! Start grounding instantly!

- The PowerBase™ Grounding Magnet sets up quickly and easily.
- Powerful rare earth magnet delivers heavy duty holding power.
- The “V” machined surface grips round parts.
- The copper connector stud allows for better conductivity.

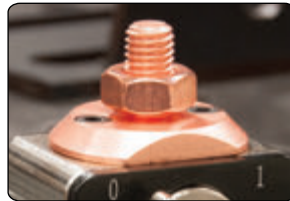

Large copper connector for better conductivity.



Holds securely onto round or flat surfaces.



The ON/OFF Lever is easy to turn, even while wearing gloves.

Part No.	Amperage	Dimension (mm)	Magnetic Force (kg)	Weight (kg)
GM203	300A @ 60% Duty Cycle	50 x 50 x 64	20	0.4
GM205	500A @ 60% Duty Cycle	50 x 70 x 64	50	1.1

Grounding Clamp

Clamping + Grounding at the same time.

Consistently rated at 300 AMPS
Solid, insulated copper U-channel rotates for easy access and can attach to round / odd-shaped parts.

GB428

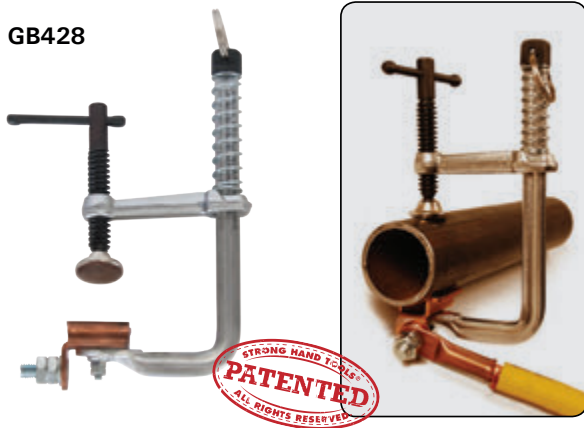

Ground Hog™ Clamp

The groove design on the copperhead seals out weld spatter and reduces particle buildup. Side screw provides a secure cable connection. Ground Hog body rotates for cable positioning.

- Controls the electrical current by isolating the contact surface and the cable connection.
- Get a smooth, continuous arc with no fade, and no heat transfer while improving cable life, and reducing power consumption.

GP2850

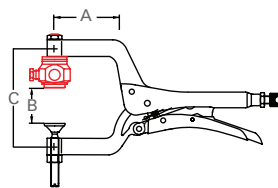

Ground Hog™

Rated at 450 AMPS @ 60% duty cycle (with 2/O cable)

Part No.	Amperage / Cable Size (mm)	Throat Depth (A) (mm)	Max.Capacity (B) (mm)	Tapped Hole (C)	Clamping Pressure (kg)	OAL (mm)	Weight (kg)
GB428	300A / --	64	75	M6	100	180	0.4
GP2850	450A / 2/O - 0.8	89	64	M10	180	280	1.1

The Third Hand & Hand Rest Kit

Time saving magnetic tools for use in the shop & in the field.

NEW

The Third Hand Modular Clamps

FULLY articulated, FULLY adjustable.

"Third Hand" positions your workpiece at any angle for full weld access.

Use your THIRD HAND to elevate and firmly hold stock at the ideal angle and height while you weld, cut, sand or paint. Securely hold stock at any position with ball joint adjustment and locking.

Universal Clamp Base Model HAS42



Welding Table Base Model HAS40

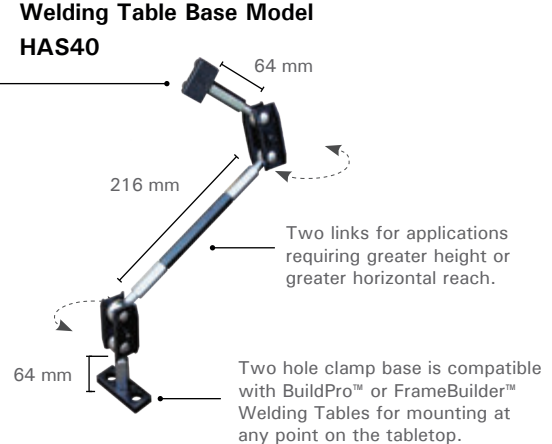

Part No.	Description	Weight (kg)
HAS42	Universal C-Clamp base model	1.1
HAS40	Welding table base model	1.6



Hand Rest Glide Kit

Unique and very practical! Use the Hand Rest to steady your hand for precise work in a fixed location. The Hand Rest platform swivels 360° on the base for support in a full arc. Or, place the hand rest base on your cut-to-length angle iron (not included) allowing you to steady your hand as you glide smoothly along in a straight line. Reduce hand and shoulder stress and fatigue. Use anywhere, anytime you need to steady your hand for precision work. Powder coated steel finish.

Kit includes Hand Rest, and 2 Magnetic Mounting Bases. Total weight: 0.68 kg. **Angle Iron NOT provided.**



MHR10

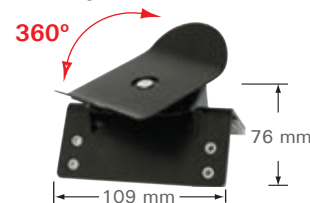

Hand Rest x 1



Magnetic Mounting Bases x 2

Grinder Rests & MIG/TIG Gun Holders

Time saving magnetic tools for use in the shop & in the field.

NEW Grinder Rests

Store your Grinder and all accessories on one convenient, compact, portable rest for easy access. The Grinder Rest holds most 125 mm Grinders.

No more searching for wrenches or spare discs!

Magnetic Base Model

MGH45

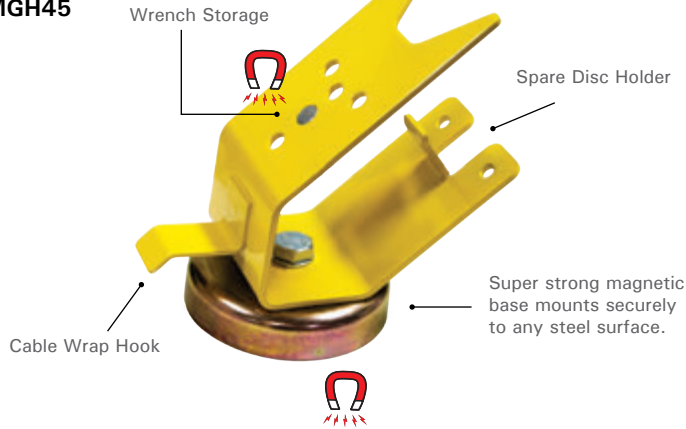

C-Clamp Base Model

MGK53

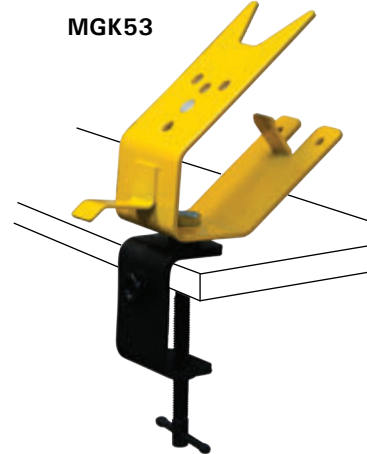

Part No.	Description	Weight (kg)
MGH45	Magnetic base model	1
MGK53	C-Clamp base model w/ vertical mounting plate	1

MIG / TIG Gun Holders

Handy Accessory Plate (included with Part Nos. MRM12) features a slot for MIG Pliers and a Nozzle Gel Canister.

Fully enclosed Magnetic Base allows easier clean up of metal fuzz.

Part No. MRM13 Kit contains the MIG Gun Holder (MRM12), and MIG Pliers (PM08).

Part No.	Description	Weight (kg)
MRM12	MIG Gun Holder with Accessory Plate	1.27
PM08	MIG Pliers	0.27
MRM13	MIG Gun Holder with Accessory Plate & MIG Pliers	1.54
MRT15	TIG Gun Holder	0.82

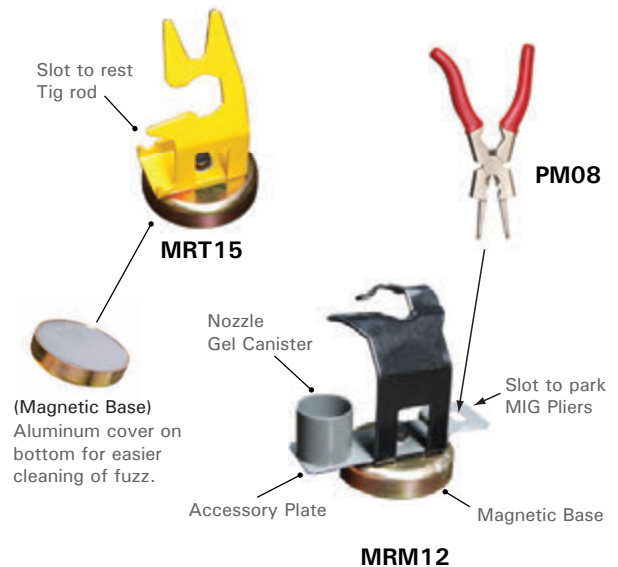

2 and 3 Axis Fixture Vises

Welders Angle Clamps

2-Axis Welders Angle Clamps

Made with machined cast iron. Featuring these improvements:

- WAC35D and WAC45 have Machined outside faces - usable for upright joint
- Stand-off increases access
- Quick acting screw on deluxe models.

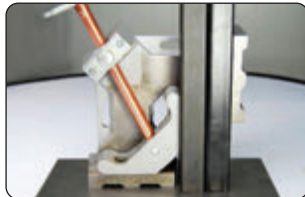

Upright Position



T-Joints



Stand-Offs



Tubes

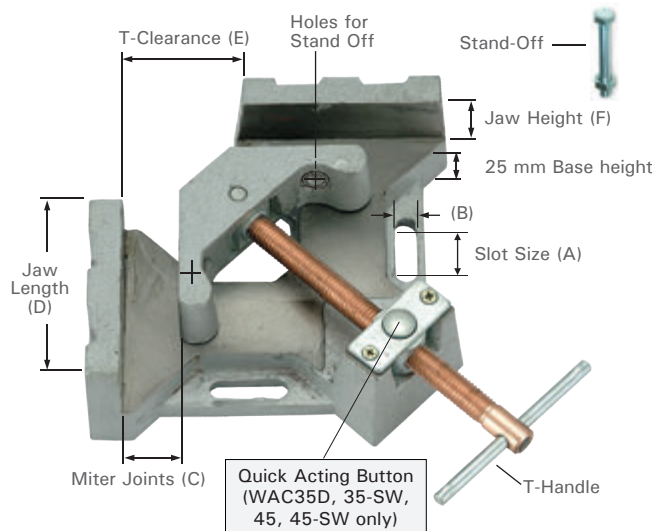

 * Optional Magnetic Rest supports workpieces.

3-Axis Welders Angle Clamps

Holds a 3-axis workpiece in position before welding.

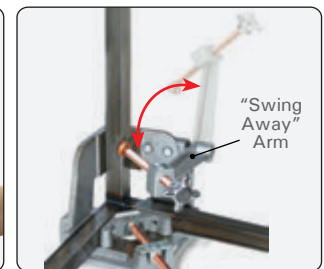

Features the **QUICK ACTING SCREWS** and **"SWING AWAY" Arm**.

Hold parts in position during cool down to minimize distortion due to contraction.

- Two Quick Acting Screws.
- "Swing away" the 3rd Axis arm for quick and easy part removal.

WAC45-SW
120 mm Capacity!

	Part No.	Features	(A) (mm)	(B) (mm)	(C) (mm)	(D) (mm)	(E) (mm)	(F) (mm)	Weight (kg)
2-Axis	WAC22	Standard screw, Machined on two outside surfaces	23.9	8.1	56	90	47	33	4
	WAC34	Standard screw	30	11	95	122	62	35	5
	WAC35D	Quick Acting Screw, Two stand-offs, Machined on two outside faces	30	11	95	122	62	35	5
	WAC45	Quick Acting Screw, Two stand-offs, Machined on two outside faces	50.9	11.1	120	135	100	57	11
3-Axis	WAC35-SW	3-Axis Fixture, Quick Acting Screw, Two stand-offs "Swing Away" Arm	30	11	95	122	62	35	11
	WAC45-SW	3-Axis Fixture, Quick Acting Screw, Two stand-offs "Swing Away" Arm	50.9	11.1	120	135	100	57	20

90° Tru AngL & Portable MagVise™

Time saving aluminum vises for use in the shop and in the field.

Aluminum 90° Tru-AngL Jig

- Accurate Right Angle Fixture.
- Weld spatter proof aluminum alloy.
- Holds round, square, flat and angle shapes.
- Works on both the outside and inside surfaces.
- Can be held in a vise.



Part No.	Jaw Length (A) (mm)	T- Clearance (B) (mm)	Jaw Height (mm)	Weight (kg)
LF-2	180	38	64	1.4

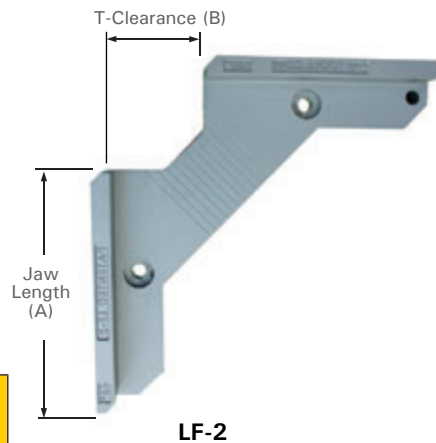

Held in vise



Used with pliers

Portable MagVise™

Use the lightweight, compact Portable MagVise for quick 90° clamping in the shop, or in the field!

Magnets in the walls instantly hold pipes, tubes, angle iron, or metal plates in position for fast, accurate clamping at 90°.



WK50

MagVise™ with Quick Acting Adjustable Spindle

WP60

MagVise™ with Pliers

WP601

MagVise™ Only

Model WK50

Features the Quick-Acting Adjustable Spindle. Press and hold the Quick Acting Button and the spindle assembly slides in and out for a super fast set-up! Release the button and the threads re-engage for tightening.

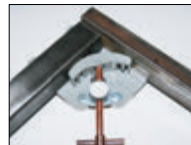

The rotatable spindle allows for holding work-pieces with different thicknesses.



The pliers can mount from front side of the MagVise.



Model WP60

Features a Pliers/Vise combination for clamping flat workpieces, such as metal plates and angle iron. Pliers can be detached from the vise for easy removal of welded stock.



Use the provided leveling screw and optional Magnetic Rests to level long workpieces.



When the job is finished, easily slide the pliers out of the WP60 MagVise.



Part No.	Features	Miter Joints (mm)	Jaw Length (mm)	T-Clearance (mm)	Jaw Height (mm)	Weight (kg)
WK50	MagVise™ with Adjustable Spindle	25	85	30	50	0.8
WP60	MagVise™ with Pliers	25	85	30	50	0.9
WP601	MagVise™ Only	25	85	30	--	0.4

Table Mount & Drill Press Clamps

Quick-set hold down clamps.

Table Mount Locking C-Clamps

Mounts directly to any work bench, drill press and fixtures.

- Mounting base hole accepts standard M8 bolts and uses push-down action to hold your workpiece securely.
- Use the Crank-Handle for pressure adjustment.
- Rapid lock and release. Ideal for repetitious clamping.

Part No.	Throat Depth (A) (mm)	Max. Capacity (B) (mm)	Mount Thread	Weight (kg)
PT11	86	100	M8	0.7
PT14	155	120	M8	0.9

PT11

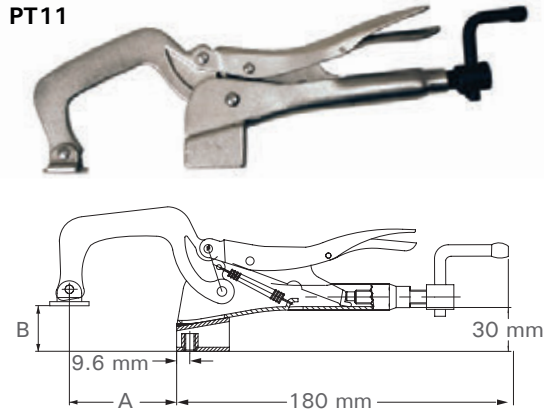

Drill Press Clamp

Secure the Drill Press Clamp to any surface, up to 25 mm thick.

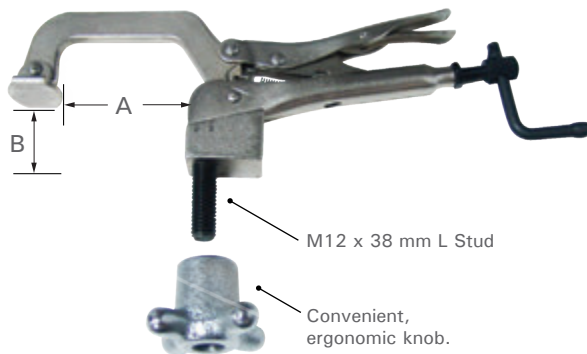

Part No.	(A) (mm)	(B) (mm)	Stud (mm)	Weight (kg)
PTD09	0-85	76	M12 x 38 L	0.9

PTD09



Crank Handles for all our pliers:

Can be purchased separately. (See accessories page 36)

Add the crank handle accessory to the clamps or pliers (See page 18 - 21) to:

- Adjust torque with the pliers in the locked position.
- Pre-set the Plier opening for repetitious clamping applications.
- Loosen the Plier before unlocking.

Part No.	Thread	For Pliers
PXH6	M6	For 152 mm , 216 mm Pliers
PXH11	M10	For 280 mm Pliers

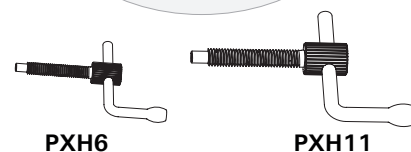

Half & Hold Down Clamps

Hold down action clamps with unique features and accessories.

Half Clamp

The Efficient, Safe Way to Align Materials.

The DOG & WEDGE and CUT-OFF C-CLAMP methods of material alignment are messy, time consuming, and unsafe!

- Align materials in the fabrication of water tanks, bulkheads, deck sections, flat plates, etc.
- For big jobs, tack weld additional 40 mm cut pipes along the joint.

How to Use

- Tack weld the front side of 1-12.5 mm pipe coupon to the lower of the two surfaces.
- Slide Half Clamp onto the cut pipe, turn the handle until the misaligned materials align.

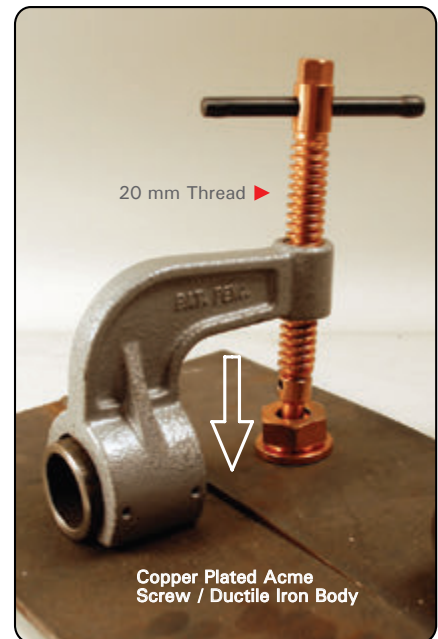
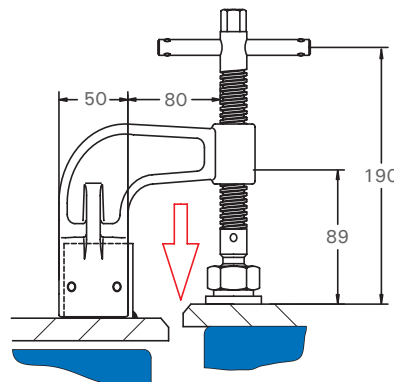
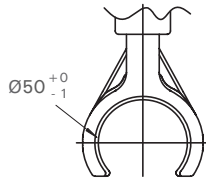
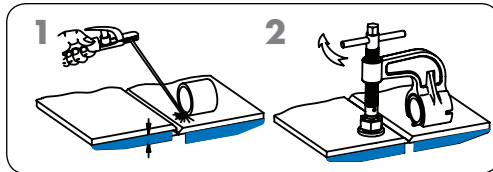

Part No.	Weight (kg)
VHC15	1.7

Hold Down Clamp

Bolt the clamp down to your worktable using the Ø10.5 hole in the base.

- The 12.5 mm copper plated Acme spindle resists weld spatter, and the swivel tip makes quick contact with your workpiece.
- Hold pipes by adding our Clip-On V-Pad, Part #XDA2. (See accessories page 37.)

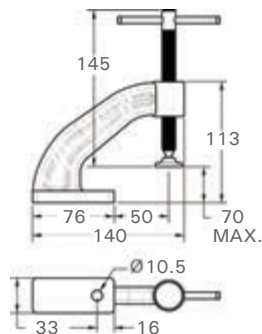

Copper Plated Acme Screw / Ductile Iron Body

Part No.	Capacity (mm)	Weight (kg)
VHD30M	70	0.9

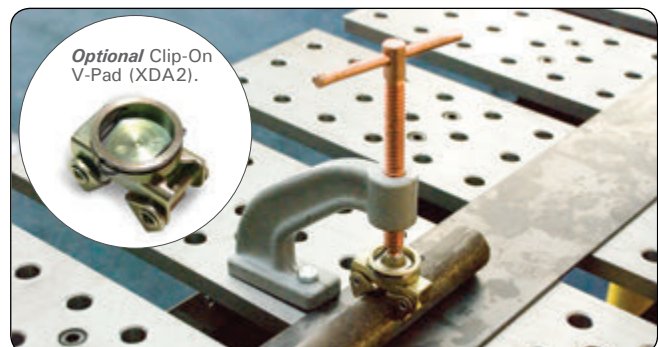

Side Clamp & Shark Clamps

Time saving tools for use in the shop & in the field.

Side Clamp

Build push-action clamp to custom heights.

Insert pipe (40 mm dia.) of desired length. Base can be bolt-mounted to the table.

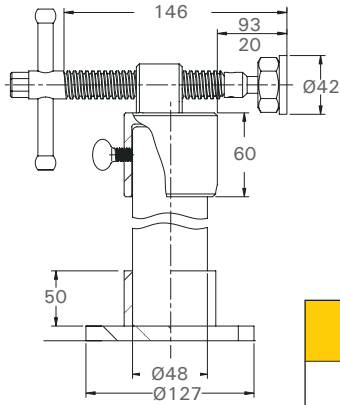

Part No.	Weight (kg)
VSC15	2.6

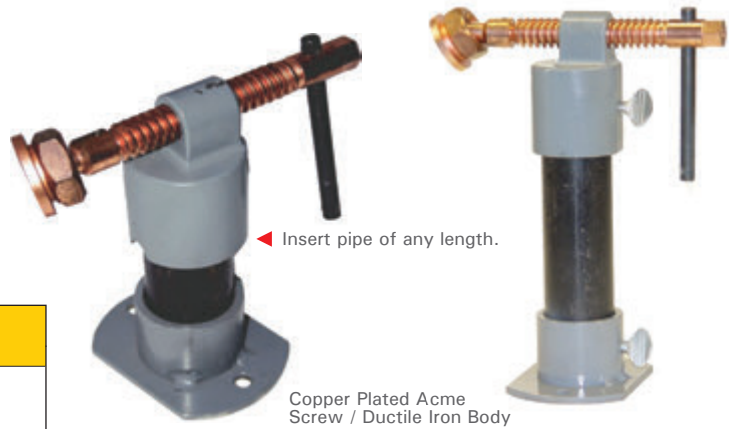

Shark Clamps

Pivoting, hinged arms provide a wide opening. Inside serrations hold workpieces securely.



C-Clamping Jaw

Quick Acting Button

Fast Set-ups, just hold the button down and pull-push the handle to desired clamping position, release the button and turn the handle to tighten.

SC50A
Straight Handle Model with soft grip

SC50
T-Handle Model (Heavy Duty)

Part No.	Description	Max. Pull Force (kg)	Opening (mm)	Weight (kg)
SC50	T-Handle	455	127	1.0
SC50A	Straight Handle	135	127	0.9
SC65	T-Handle	455	165	1.1
SC65A	Straight Handle	135	165	1.0

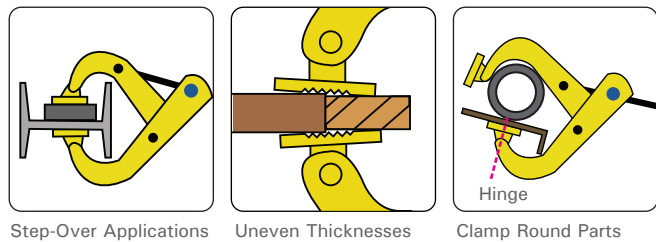

Platen Clamps & Accessories

Platen and Universal Tabletop Clamps.

Modular Platen Clamps

For fast, secure clamping, simply insert the clamp into the 44.2 mm square hole in your acorn platen. Slide the clamp arm down to the work piece and turn the T-Handle to tighten.

- Choose from Acorn Bushing or Table Mount Models.
- Clamp comes with standard or heavy duty Swivel Pads.
- Unique optional Side-Kick Attachment provides push-action horizontal clamping force. *(See accessories page 37)*
- Optional V-Pads can be mounted on the Sliding Arm or Side-Kick Attachment. *(See accessories page 37)*

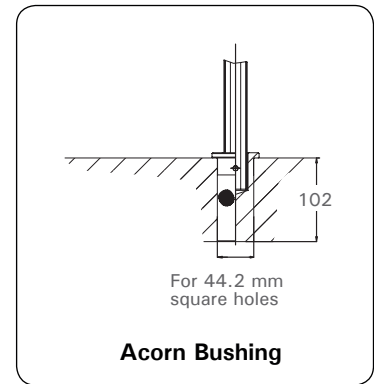
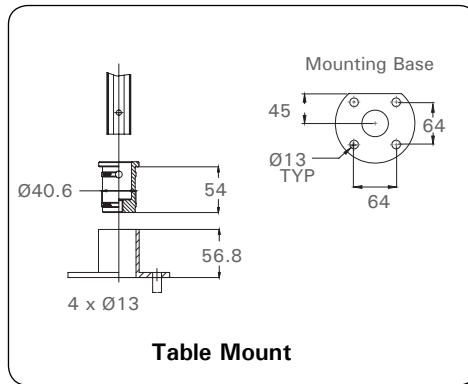

Table Mount

Part No.	Rail Size	Pad	Opening (mm)	Throat (mm)	Weight (kg)
UF8NC	"F"	Standard	203	120	2.2
UF10NC	"F"	Standard	254	120	2.2
UF12NC	"F"	Standard	305	120	2.4
UM12NC	"M"	HD	305	140	3.6
UM16NC	"M"	HD	406	140	4.0
UM20NC	"M"	HD	508	140	4.3

Acorn Bushing

Part No.	Rail Size	Pad	Opening (mm)	Throat (mm)	Weight (kg)
UF8NA	"F"	Standard	203	120	2.3
UF10NA	"F"	Standard	254	120	2.4
UF12NA	"F"	Standard	305	120	2.4
UM12NA	"M"	HD	305	140	3.6
UM16NA	"M"	HD	406	140	4.0
UM20NA	"M"	HD	508	140	4.4

Screw-on V-Pads

Attach to the top of Utility Clamps equipped with Heavy Duty Pads.

(See Page 37 for accessories details.)

XMA

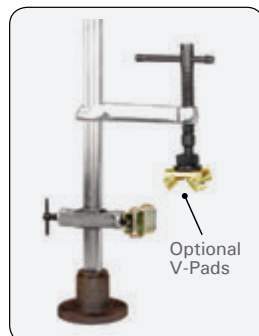

Slide-on Sidekicks

Mount onto Clamps for 2-axis horizontal clamping.

(See Page 37 for accessories details.)

XFSM / XGSM / XMSM



XDSM



MagBrace & Panel Clamps

Time saving magnetic tools for use in the shop & in the field.

MagBrace

Position stock at 90° on round, square, or angled structures before tack welding. The MagBrace creates a rest for secure holding and positioning of stock. Magnets on the face of the 46 mm rest provide light duty holding of stock. Made of machined aluminum die casting. Choose from MagBrace only (Mount with your own clamp) or MagBrace & Clamp Set.

MX50

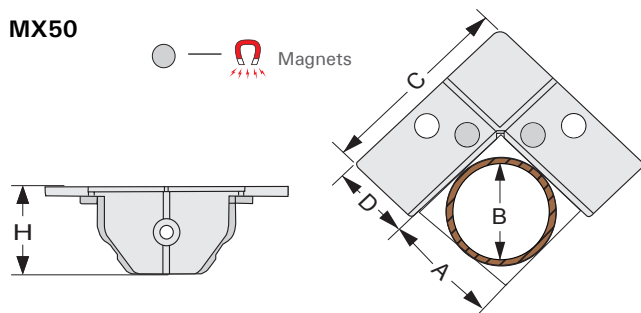

UBB65

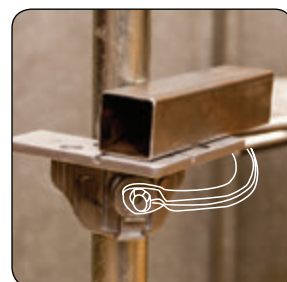
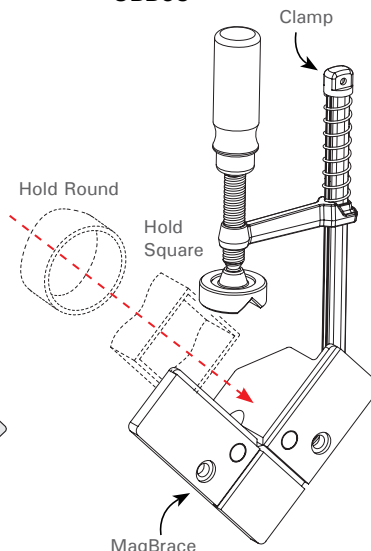

Mount MagBrace with clamping device.

Part No.	Description	A (max square) (mm)	B (max Ø) (mm)	C (mm)	D (mm)	H (mm)	Weight (kg)	
MX50	MagBrace with 2 magnets	76 x 76	70	114	46	61	0.3	
UBB65	MagBrace mounted on clamp w/ Spring-loaded arm	MagBrace same as above						0.7

Panel Clamps

Magnets hold clamp parts and panels together!

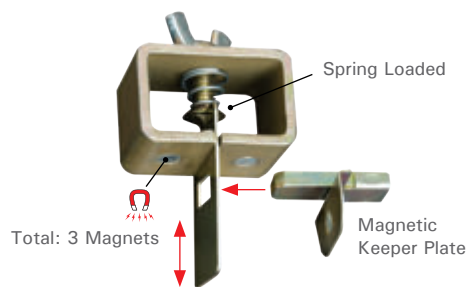

- Magnets in the Keeper Plate and the clamp body hold your panels in position for a speedier, and more efficient setup. NO MORE fumbling while trying to hold the panels and the clamps!
- Turn the spring-loaded screw to adjust the opening to accept panels of different thicknesses [Max. 5 mm].
- Wider-than-standard clamp body holds your panels flatter, for a more precise setup. Panels will not spin out of alignment.
- A magnet in the Keeper Plate holds your panels together even when used in the vertical position.

Part No.	Description	Weight (kg)
MPC12	Panel Clamps, Twin Pack	0.1

Mag-Levels & Handi-Hammers

Innovative magnets and levels with unique and updated features.

Torpedo Mag-Levels

LM3723

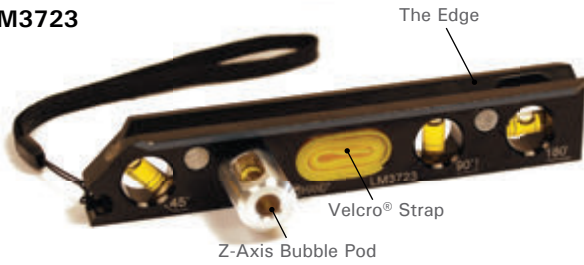

LM2422



Mini Torpedo Mag-Level

- Compact & Light Weight
- Z-Axis Bubble Pod
- V-Groove for round parts
- 4 Magnets



The use-anywhere, view anywhere compact magnetic level.

- 4 strong magnets allow hands-free use on metal surfaces.
- V-Groove on one side for pipe and conduit work.
- Robust, solid anodized aluminum body.

	6.5 mm Lip Allows the level to be easily aligned with the side of the workpiece.
	Z-Axis Bubble Pod The add-on pod provides accurate leveling of 2-axes. The pod can be rotated for easy viewing from different angles and heights.
	Elastic Velcro® Strap (LM3723 only) Allows the level to be easily attached to non-magnetic surfaces. The strap fits snugly into the hole for safe keeping.

Part No.	Dimension (mm)	Angles	Weight (kg)
LM3723	180 x 32 x 25	0°, 45°, 90°	0.2
LM2422	100 x 32 x 25	0°, 90°	0.1

Mag-Level

- The only magnetic level with the On/Off switch.
- Holds securely to round and flat surfaces.
- Three vials for 0°, 45°, 90° reading.

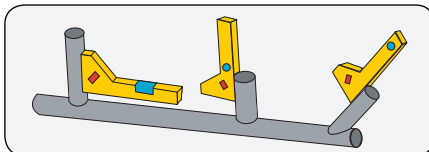
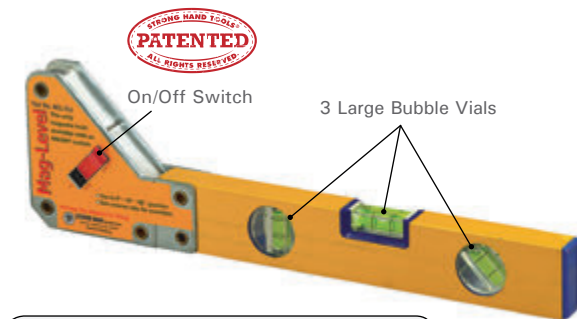

MSL-316

Part No.	Angles	Dimension (mm)	Max. Pull Force (kg)	Weight (kg)
MSL-316	45°, 90° 180°	100 x 406 x 25	30	0.9

*Magnetic force is based on 10 mm thick steel.

Handi-Hammers - The handle-less Tapper!

The Unique dual face Dead-Blow Tapper

- One Steel End for hard surfaces.
- One Soft Face for non-marring applications.
- Eliminates bounce back and increases impact.
- Fits easily in Tool Kits, Tool Boxes & Work Bench Drawers.
- Ideal for confined areas!

CH-14



Part No.	Dimension (mm)	Weight (kg)
CH-10	∅ 40 x 127	0.3
CH-14	∅ 45 x 133	0.4

NOMAD™ Economy Welding Table

Very Affordable. Fully Adjustable. Easily Movable.

The Nomad Economy Welding Table is engineered to provide a safe, transportable, affordable, and versatile welding surface.

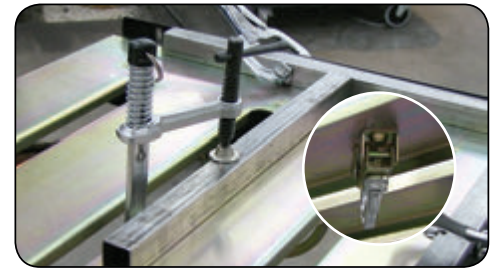

The MagSpring Clamps can be inserted into the 28 mm slots on the Nomad Tabletop for hold down clamping. Magnetic V-Pad jaw holds underneath the table to keep the clamp in the up-right, "ready to use" position.

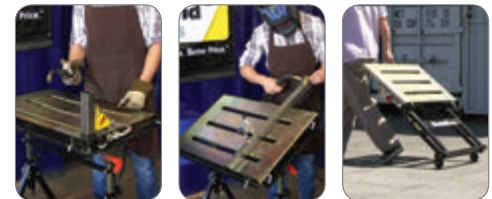

Part No.	Tabletop Size (mm)	Table Height Range (mm)	Slot in Tabletop (mm)	Table Positions	Load Capacity (kg)	Weight (kg)
TS3020	760 x 510	660 - 810	28	0°, 30°, Folded	160	20

The Nomad Economy Tool Kit is ideal for clamping and positioning stock on the Nomad Table.

Nomad™ Economy Tool Kit

Part No. TSK104M

- MagSpring Clamps** (UBV45M - 75 mm Cap.)
- Multi-Angle Magnet** (MS346C)
- Mini Magnet** (MS346A)
- Adjustable Magnetic V-Pads** (XDV4 - 4 magnets)

- MagSpring Clamps** - Spring loaded arm for fast opening.
- Multi-Angle Magnet** - Hold stock at: 30°, 60°, 45°, 90°.
- Mini Magnet** - Low profile for tight space holding.
- Magnetic V-Pad** - Hold and elevate round, square, flat and angled stock.

Nomad™ Connector Plate

Need more tabletop workspace? Use the Nomad™ Connector Plate to join two Nomad Tables together to create a 2.3 m long workstation!

Clamp and work on larger projects, or multiple projects with the fully adjustable work surface! There are thru holes on all four sides of the Connector Plate for multiple mounting options.



TSL30 (Includes all mounting screws)

Part No.	Weight (kg)
TSL30	7.4

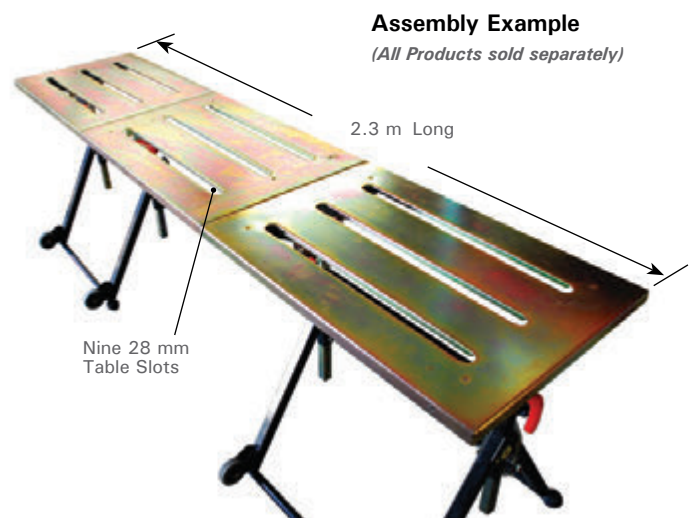

Strong Hand Tools® Clamping Kits

Receive 10% off list price on the clamping kits and receive a **FREE** gift!

Having the right tools on hand makes every job easier to complete. These kits contain the most essential tools for clamping, holding, and positioning steel. Efficiency + Cost Savings are an unbeatable combination.

All items can be purchased separately.

Utility Clamp Kit #1

Part No. UDMK4-5 Weight: 2.1 kg

1  **UD45M**
 - Capacity: 114 mm
 - Clamping Pressure: 227 kg
 - Throat Depth: 83 mm

1  **UD65M**
 - Capacity: 165 mm
 - Clamping Pressure: 227 kg
 - Throat Depth: 83 mm

1  **UD85M**
 - Capacity: 216 mm
 - Clamping Pressure: 227 kg
 - Throat Depth: 83 mm

2  **GIFT
FREE V-Pads (XDV)**
 - UD Clamping accessory
 - Holds round and angled workpieces.

Utility Clamp Kit #2

Part No. UFMK4-4 Weight: 4.3 kg

1  **UF65M**
 - Capacity: 165 mm
 - Clamping Pressure: 454 kg
 - Throat Depth: 120 mm

1  **UF100M**
 - Capacity: 254 mm
 - Clamping Pressure: 454 kg
 - Throat Depth: 120 mm

1  **UF100RM**
 - Ratchet Action Utility Clamp
 - Capacity: 216 mm
 - Clamping Pressure: 454 kg
 - Throat Depth: 120 mm

1  **GIFT
FREE Sidekick (XFSM)**
 - Fits all UF Rails
 - Allows for 2-axis horizontal clamping.

Adjust-O Magnet Kit

Part No. MK4-4 Weight: 2.8 kg

1  **MSA45**
 - Adjust-O™ Magnet Square
 - Hold at 45° & 90°
 - Max. Pull Force : 30 kg

1  **MSA53-HD**
 - Adjust-O™ Magnet Square
 - Hold at 30°, 45°, 60°, 90°
 - Max. Pull Force : 64 kg

1  **MSL-316**
 - Mag-Level with On/Off Switch
 - Three vials for 0°, 45° & 90° reading
 - Max. Pull Force : 32 kg

1  **GIFT
FREE Magnetic Post Set**
 - 3rd-Axis Magnetic Posts (MXE13)
 - Easily set-up 3-axis workpieces.
 - Fits all Adjust-O™ Magnet Squares

Magnetic Clamping Kit

Part No. TSK104M Weight: 1.4 kg

2  **UBV45M**
 - MagSpring™ Clamp
 - Capacity : 75 mm
 - Throat Depth : 64 mm

1  **MS346C**
 - Standard Magnet Squares
 - Hold at 30°, 45°, 60°, 90°
 - Max. Pull Force : 39 kg

2  **XDV4**
 - Magnetic V-Pads
 - Light duty & tight spot holding
 - Build, hold, and position steel

1  **GIFT
FREE Mini-Magnet**
 - Original Mini Magnet (MS346A)
 - Hold at 30°, 45°, 60°, 90°
 - Max. Pull Force : 10 kg

Accessories

Replacement Parts and Accessories.

U-Clamps Replaceable Parts

Replaceable Arm & Spindle Kits

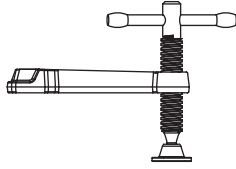

P/N	For U-Clamps Series
XER	UE Series
XFR	UF Series
XGR	UG Series
XMR2	UM Series (Equipped with H.D. Pad)
XMRP2	UM Series (Equipped with Standard Pad)
XPR	UP Series

Individual Clamp Arms & Spindles

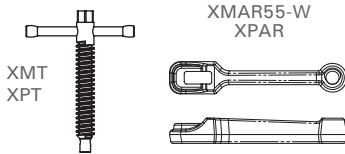

P/N	Description
XMT	Spindle for UM Series
XPT	Spindle for UP Series
XMAR55-W	Clamp Arm for UM Series
XPAR	Clamp Arm for UP Series

Spring Stop Replacement Kit

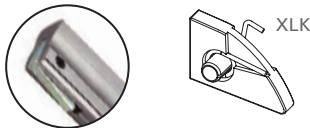

P/N	Description
XLK	For UE, UF, UG & UM series clamps.

Pliers Replacement Parts

Spring & Adjustment Bolt for Pliers

Spring - 4 per set
PXS11
PXS6



Adjustment Bolt

PXB11
PXB6



P/N	For Pliers
PXS11	280 mm Pliers
PXS6	165 mm - 216 mm Pliers
PXB11	280 mm Pliers
PXB6	165 mm - 216 mm Pliers

Swivel / Pivot Pads (For Pliers)

Flat pads pivot at 150° and round pad swivels at 360°.

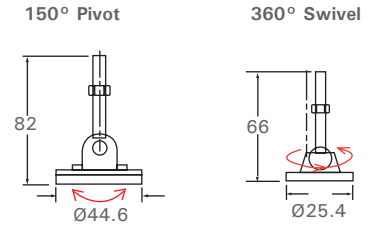

P/N	Thread	Height	Pad OD
854944M (Pivot)	M10	82 mm	Ø44.6 mm
854940M (Swivel)	M10	66 mm	Ø25.4 mm

Crank Handles (For Pliers)

Optional or replacement handles for all Strong Hand Tools™ Pliers.

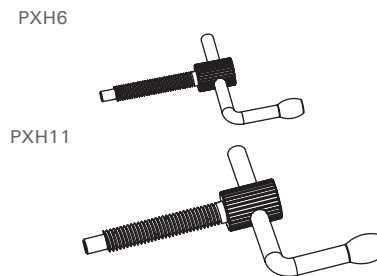

P/N	Thread	For Pliers
PXH11	M10	280 mm Pliers
PXH6	M6	165 mm - 216 mm Pliers

Big Hex Spindles (For Pliers)

Fixed head spindles for Multi-Purpose Pliers.

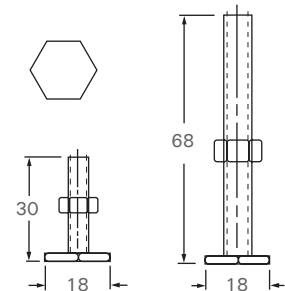

P/N	Thread	Length
854714M	M10	66 mm
854713M	M8	30 mm

Heavy Duty Replaceable Pads

Replacement joints and pads for UM & UP clamps.

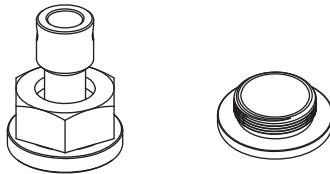

P/N	Description
XMJ	Joint & Pad Kit for UM & UP Clamps
XMA1	Replacement Pad only

Fixed Glides (For Pliers)

With non-marring rubber pads.

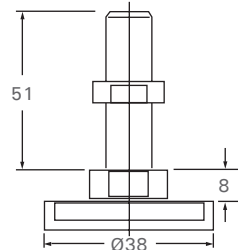

P/N	Thread	Length
854740PM	M10	51 mm

T-Strap Bolts (For Pliers)

For Step-Over applications.

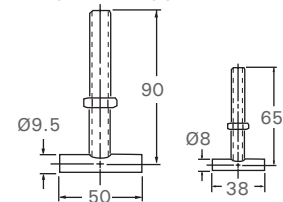

P/N	Thread	Length
840435M	M10	89 mm
840335M	M8	64 mm

Accessories

Accessories for Utility Clamps, Multi-Purpose Pliers and Expand-O Pliers.



V-Pads (For U-Clamps & Pliers)

Standard V-Pads

To hold round & angled workpieces.

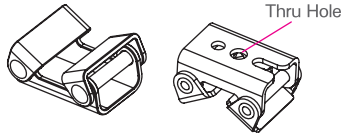

P/N	Material	Thru Hole	For Clamps	For Pliers
XDV		M8	UD Series	PG622 / PG634
XFV		M10	UE, UF, UG Series	PG114M / PG134M / PG204M / PGA20M
XMV		M10	UM, UP Series	--
XPV		M10	UP Series	--
XDVS	Stainless Steel	M8	UD Series	PG622 / PG634
XFVS	Stainless Steel	M10	UE, UF, UG Series	PG114M / PG134M / PG204M / PGA20M
XMVS	Stainless Steel	M10	UM, UP Series	--

Pliers Replacement Parts

Rare earth magnetic V-Pads for holding round and angled pipes.

2 magnets Version (Top only):

XDV2 / XFV2

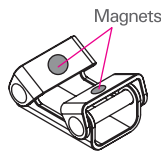

4 magnets version (Top & Bottom):

XDV4 / XFV4

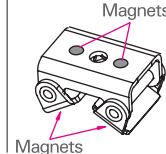

» XDV4 & XFV4 are table mount versions.

P/N	Thru Hole	For Clamps	For Pliers
XDV2	M8	UD Series	PG622 / PG634
XDV4	M8	--	--
XFV2	M10	UE, UF, UG Series	PG114M / PG134M / PG204M / PGA20M
XFV4	M10	--	--

4-IN-1 Packages (For U-Clamps)

Convert all Utility Clamps into 4-IN-1 Clamps. Includes a V-pad, an Extender Block, and a screw.

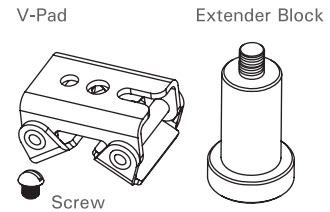

P/N	V-Pad / Extender Block
XDVBM	XDV / XDB1M (For UD Models)
XFVBM	XFV / XFBM (For UE, UF, UG Models)
XMVBM	XMV / XMB2M (For UM, UP Models)
XPVBM	XPV / XMB3M (For UP Models)

Top V-Pads (For U-Clamps)

Attach to the top of Utility Clamps equipped with **Standard Pads**.

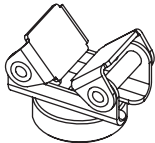

» Light Duty & Value Series

P/N	Material	For U-Clamps Series
XDA2		UD Series
XFA2		UE, UF, UG Series
XMA2		UM, UP Series
XDA2S	Stainless Steel	UD Series
XFA2S	Stainless Steel	UE, UF, UG Series
XMA2S	Stainless Steel	UM, UP Series

Screw-On V-Pads

Attach to the top of Utility Clamps equipped with **Heavy Duty Pads**.

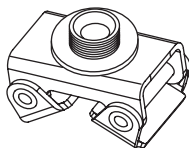

» For Regular and Heavy Duty Series

P/N	Material	For U-Clamps Series
XMA		UM, UP Series
XMAS	Stainless Steel	UM, UP Series

Extender Blocks (For U-Clamps)

Attach to U-Clamps for Step-Over and Spreading applications.

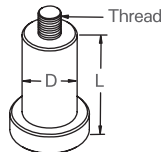

P/N	Thread	D	L	For Clamps
XDB1M	M8	16 mm	25 mm	UD Series
XFBM	M10	18 mm	51 mm	UE, UF, UG Series
XMB2M	M10	22 mm	51 mm	UM, UP Series
XPB3M	M10	28 mm	75 mm	UP Series

Sidekicks (For U-Clamps)

Mount onto U-Clamps for 2-axis horizontal clamping.

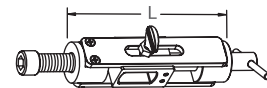

P/N	L	Stroke	For Clamps
XDSM	79 mm	25 mm	UD Series
XFSM	111 mm	35 mm	UF Series
XGSM	111 mm	35 mm	UG Series
XMSM	111 mm	35 mm	UM Series

Bench Rests (For U-Clamps)

Supports U-Clamp in Standing Position.

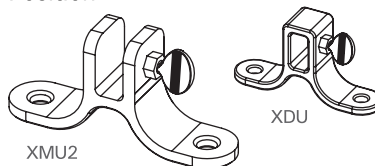

P/N	For U-Clamps Series
XDU	UD Series
XMU2	UM Series

Pipe Adaptors (For Expand-O)

Attach to Expand-O Pliers for wide spreading jobs and U-clamps for Step-Over applications.

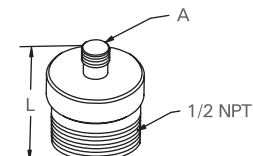

P/N	L	A	For Expand-O	For Clamps
XDJM	27 mm	M8	PE6M, PE62M	UD Series
XFJM	29 mm	M10	PE10M	UE, UF, UG, UM, UP



Toggle Clamps

Ideal time-saving jig and fixture clamps.
www.goodhandinc.com



Components

Standard Machine Parts & Tooling Components.
www.valtrainc.com

Vertical Handle
Hold Down Action

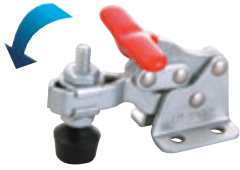

Horizontal Handle
Hold Down Action



Push/Pull
Straight Line Action

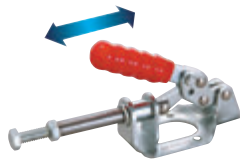

Latch Type
Pull Action



Cam Type
Hold Down Action

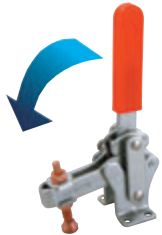

Toggle Pliers
Squeeze Action



F-Type
Pull Down Action

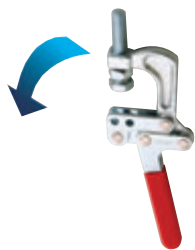

Pneumatic Power



Yoke Assemblies



Heavy Duty Weldable
Hold Down Action



Bedding Supports



Cam Action Clamps



Forged Adjusta-Clamps



Adjustable Handles



Center Cam Clamps



Rotary T-Slot Nuts



Handwheels



Spring Stops



Handknobs



Cap Screw Hook Clamps



Speed Ball Handles



Lifting Eyebolts



Leveling Pads



Crank Handles



Heavy Duty Fixed Glides



Clamping Levers



T-Slot Bolts



Rotary T-Slot Bolts



Plain Eyebolts



T-Strap Bolts



Contact us for complete catalog.

BuildPro™ Welding Tables

Faster Fixturing. Consistent Results. Greater Productivity.

www.buildprotables.com

The affordable, professional BuildPro™ Welding Tables are setting a new standard in price and performance.

The BuildPro's modular design gives you the flexibility to adapt to each new project easily. You'll work more safely and efficiently, so you can increase both your productivity and quality of work.

Precision, ground steel plates, with CNC machined 16 mm holes in a 50 mm grid pattern for locating, positioning and holding your fixture with the BuildPro™ clamps and components.

Plates can be reconfigured to extend the width of the table for larger projects.

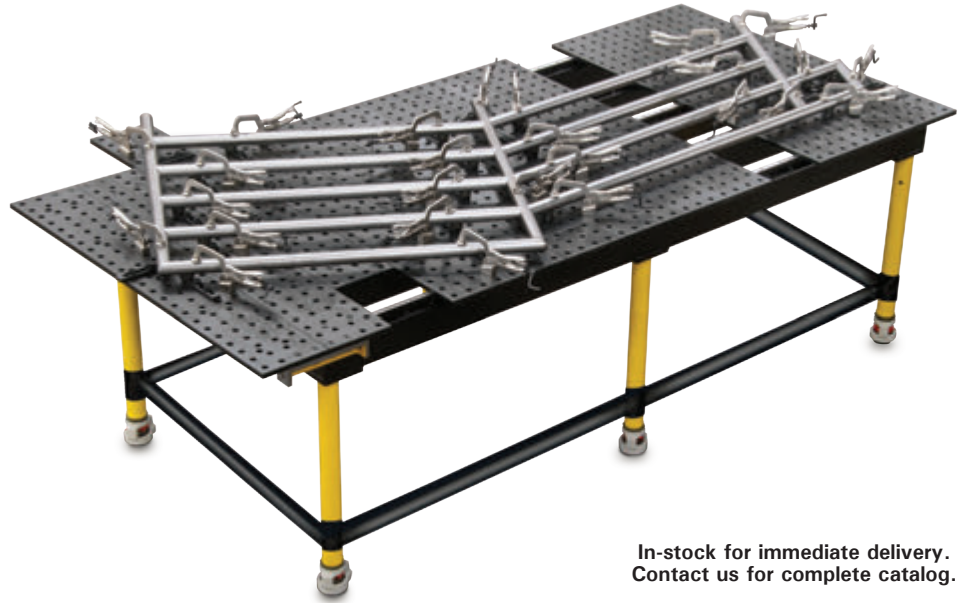

In-stock for immediate delivery.
Contact us for complete catalog.

SIEGMUND®

High Precision Welding Tables and Clamping Systems.

www.siegmundtables.com



Made in Germany

Precision CNC machined 28 mm dia. holes cover the five table faces in a 100 mm grid pattern for flexibility in the design and set-up of fixtures.

Visible grid lines on the tabletop help you align and position your workpiece for fixturing.

All Siegmund Welding Tables feature a *plasma nitride* finish for superior surface hardness, improved load capacity, long life, and protection against weld spatter and corrosion.

Siegmund Welding Tables feature a ONE PIECE, FIVE-FACE design with 25 mm thick reinforced steel plate for an extremely rigid and flat work surface.



In-stock for immediate delivery.
Contact us for catalog.

StrongHandTools

www.stronghandtools.com



☎ 1.562.949.8625

📠 1.562.949.4875

✉ sales@stronghandtools.com

📍 7141 Paramount Blvd.,
Pico Rivera, CA 90660, U.S.A.

©2015. All Rights Reserved.