

Sapphire nozzle 063



Properties and advantages

- Long lifetime
- Constant jet quality
- High-power and focused water jet
- Needle jet with high energy density
- Easy to install and disassemble
- Swiss Quality

Applications

- Construction industry
- Iron, steel and metal industries
- Mechanical and apparatus engineering
- Cement and concrete industry
- Industrial cleaning
- Spray bars

Description

The Sapphire nozzle type 063 can be used up to an operating pressure of 3000 bar. This nozzle is mainly used for spray bars and its utility in the industrial cleaning or on marking removal machines. The sapphire and nozzle body are manufactured and processed in-house. The nozzle gets sealed on the edge of the cone and has a sealing angle of 86°.

The heart of the nozzle, its the sapphire that is completely manufactured by mvt AG, thus ensuring a consistent and high quality. All sapphire are checked for scratches, cracks and flow.

ART. NO. (1)

33018._ _

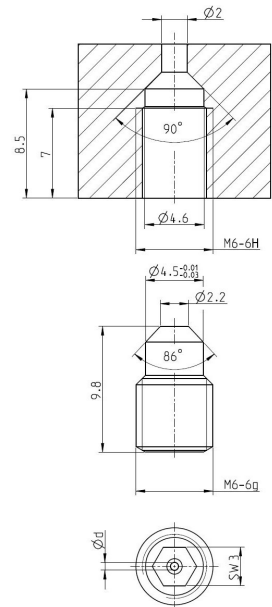

CHARACTERISTICS	TYPE
	063
Operating pressure (bar)	max. 3000
Operating temp. (°C)	max. 150°
Tightening torque (Nm)	max. 5

Performance

ART. NO.	NOZZLE SIZE IN US GAL/MIN AT 40 PSI	NOZZLE ØD MM	PRESSURE IN PSI / BAR							
			psi 2900	psi 7250	psi 10875	psi 14500	psi 21750	psi 29000	psi 36250	psi 43500
			bar 200	bar 500	bar 750	bar 1000	bar 1500	bar 2000	bar 2500	bar 3000
			FLOW RATE IN L/MIN							
33018.0100	0002	0.10	0.064	0.100	0.122	0.141	0.171	0.196	0.217	0.237
33018.0125	0003	0.125	0.100	0.157	0.191	0.220	0.267	0.306	0.340	0.370
33018.0150	0004	0.15	0.143	0.226	0.275	0.316	0.385	0.441	0.489	0.532
33018.0175	0006	0.175	0.195	0.307	0.375	0.431	0.523	0.600	0.666	0.725
33018.0200	0008	0.20	0.255	0.401	0.489	0.563	0.684	0.784	0.870	0.946
33018.0250	0012	0.25	0.399	0.627	0.764	0.879	1.068	1.224	1.359	1.479
33018.0300	0018	0.30	0.574	0.903	1.101	1.266	1.538	1.763	1.957	2.130
33018.0350	0024	0.35	0.781	1.229	1.498	1.723	2.094	2.400	2.664	2.899
33018.0400	0031	0.40	1.020	1.605	1.957	2.251	2.735	3.134	3.479	3.786
33018.0450	0040	0.45	1.291	2.031	2.477	2.848	3.461	3.967	4.403	4.792
33018.0500	0049	0.50	1.594	2.507	3.058	3.517	4.273	4.897	5.436	5.916
33018.0550	0059	0.55	1.929	3.034	3.700	4.255	5.170	5.925	6.578	7.158
33018.0600	0071	0.60	2.296	3.611	4.404	5.064	6.153	7.052	7.828	8.518
33018.0650	0083	0.65	2.694	4.238	5.168	5.943	7.221	8.276	9.188	9.997
33018.0700	0096	0.70	3.125	4.915	5.994	6.892	8.375	9.598	10.655	11.595
33018.0750	0110	0.75	3.587	5.642	6.880	7.912	9.614	11.018	12.232	13.310
33018.0800	0125	0.80	4.081	6.419	7.828	9.002	10.939	12.536	13.917	15.144
33018.0850	0142	0.85	4.607	7.247	8.838	10.163	12.349	14.152	15.711	17.096
33018.0900	0159	0.90	5.165	8.124	9.908	11.394	13.844	15.866	17.614	19.166
33018.0950	0177	0.95	5.755	9.052	11.039	12.695	15.425	17.678	19.625	21.355
33018.1000	0196	1.00	6.377	10.030	12.232	14.066	17.091	19.588	21.746	23.662

Instructions

When manually operating high pressure guns and lances the repulsive force on the axis should not exceed 250N! If the repulsive force exceeds 150N, a support / body armour is required!

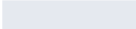
	< 150 N
	< 250 N
	> 250 N