

Horizontal wrapping machine

CL 040-400 / 600 / 800 / 1000 / 1200

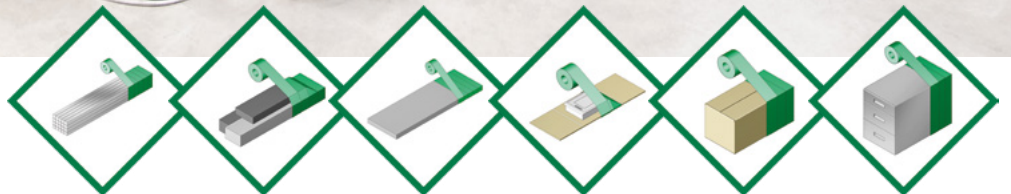

A machine for uni-
versal application



Fix. Wrap. Pack.



Machine description

The **CL 040** was designed according to our sophisticated, well-established solutions for your applications, which have proven their worth in the market, and is fully CE compliant. It is a **manually operated Circle Line wrapping machine** that can be used for **long goods, stack packaging, tray packaging, cardboard boxes, sheet formats and furniture**.

Simple parameter input on an operating unit **complements** this machine's equipment and expands its application range. The machine has an **easily accessible bundling and wrapping program** with an **adjustable wrapping ring speed**.

The **work table** with PVC-coated rollers can be **height-adjusted** to fit the task, depending on its purpose and the product. The continuously adjustable braking roller ensures **an even film tension** and high product wrapping quality.

Our special machine design allows for **risk-free operation** directly in the wrapping area of this modern, reliable wrapping machine.

Application:

The products are **manually pushed** into the wrapping area on the roller conveyor of the machine. The operator grips the film and uses **the foot pedal switch** to start the wrapping ring drive.

After the second revolution, the start of the film is **fastened in place** and the bundling or wrapping process can be continued. If the foot pedal switch is released, the wrapping ring **stops at the position** in which the film can be **freely gripped and torn off**. The film tail is pressed to the product by hand.



Equipment features

The basic machine can be equipped with three different film accommodation mandrels with diameters of 30, 38 or 76 mm.

Design features

You decide based on your desired market image which special RAL colours to use for the machine supplied by us.

All machines from Wrapsolut can be used inline. More info under www.wrapsolut.de

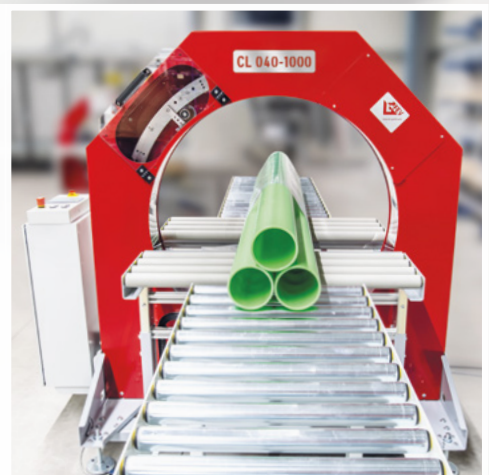
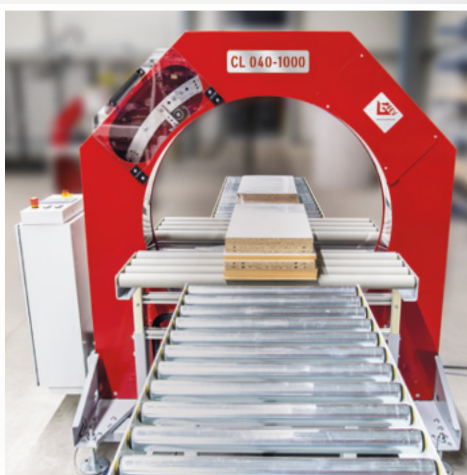
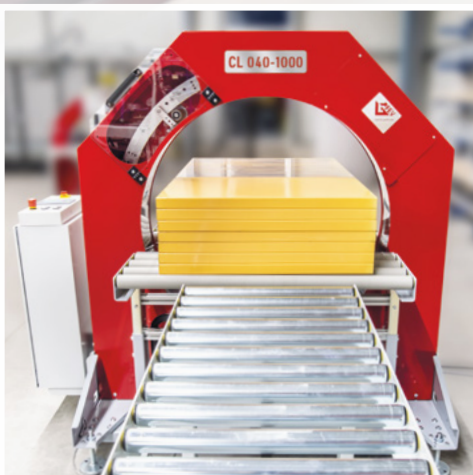

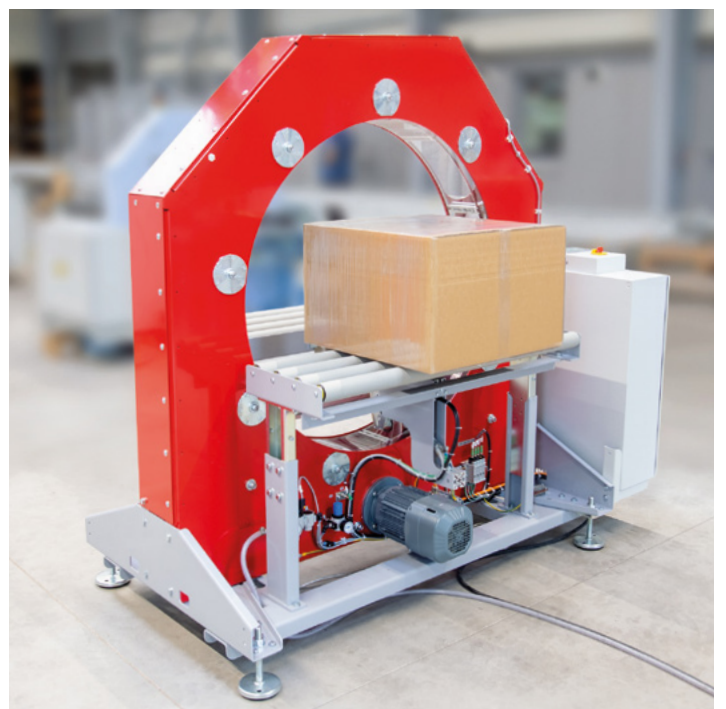

Accessories

✓ Tongue in wrapping area

The tongue in the wrapping area is an aid for supporting flexible and/or short products during transfer from the infeed to the outfeed conveyor and holding them in place during the wrapping process.

✓ Manual ring height adjustment

A button is used to move the wrapping ring height in relation to the conveying level to ensure uniform film tension and therefore a high wrapping quality during the wrapping process. The ring height adjustment is advisable for large height differences in the products.



Technical data for CL 040 - 400 bis 1200

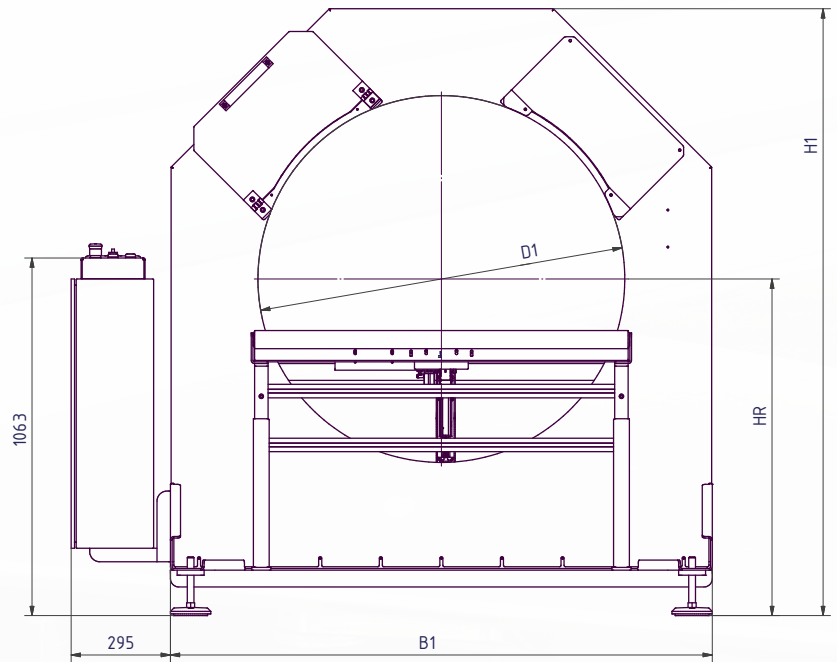
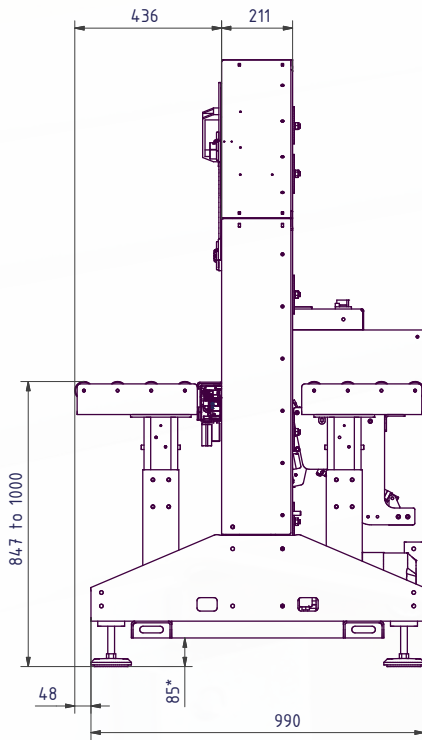

* adjustable between 45 mm and 115 mm
Dimensions in mm
Technical changes reserved

machine size	D1	B1	HR	H1
CL 040 - 400	490	1010	900	1400
CL 040 - 600	690	1210	900	1500
CL 040 - 800	890	1410	900	1600
CL 040 - 1000	1090	1610	1000	1800
CL 040 - 1200	1290	1810	1100	2000

- Operating unit for:
 - ring speed
 - automatic film holder and swivel cutter, selectable ON/OFF
 - sealing unit selectable ON/OFF
 - selectable number of wrapping layers and bundling process
 - service area
- Safety closing mechanism of the film change flap

Product cross section	400 / 600 / 800 / 1000 / 1200 (maximum)
Wrapping ring speed	4.1 / 3.5 / 2.8 / 2.4 / 1.9 (per second, maximum)
Film width	125 mm (maximum)
Film roll exterior Ø	220 mm (maximum)
Roll core / film accommodation mandrel	available in Ø 30 mm, 38 mm (1,5"), 76 mm (3")
Electrical connection	Mains voltage 3 x 400V+N+PE Power plug 16A / CEE Control voltage 24VDC
Pneumatic connection (required for automatic film holder and sealing unit)	Supply pressure 6 to 12 bar Air treatment dried / oil-free Plug-in coupling, nominal diameter 7.2

✓ Automatic film holder and swivel cutter

The wrapping material is neatly cut by the automatic film holder and swivel cutter (provided the material width is even) and placed straight against the product.

✓ Sealing unit

The film tail which was neatly placed by the automatic film holder and swivel cutter is thermally sealed with the previously wrapped film layers and permanently fastened in place.



Tongue in wrapping area with sealing unit



Film roll pick up unit with external brake roll



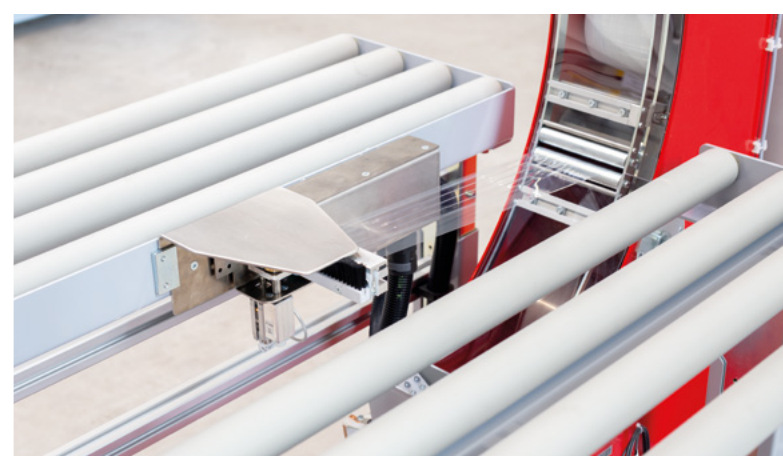

Our customised solutions for your industry through:

- ✓ technical consultation and project support
- ✓ machine development (mechanical and electrical)
- ✓ PLC control development and programming
- ✓ machine production and assembly
- ✓ delivery, commissioning and instruction
- ✓ reliable and quick service and delivery of spare parts

All machines from Wrapsolut can be used inline. More info under www.wrapsolut.de

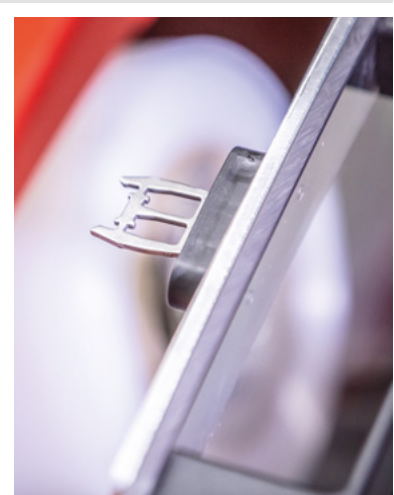
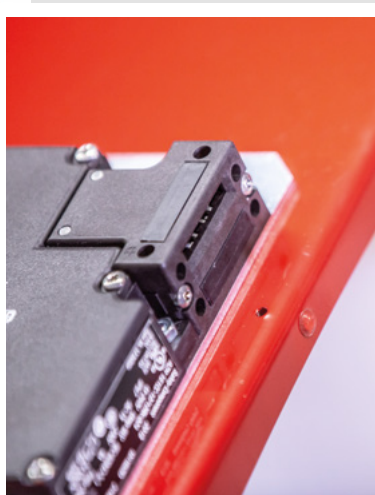

Fährenkämper GmbH & Co. KG

Kampstraße 35
D-32584 Löhne

Fon: + 49 (0) 57 31 / 8 60 01-0
Fax: + 49 (0) 57 31 / 8 60 01-11

E-Mail: info@faeco.de
Internet: www.wrapsolut.de